

Individual Student Notebooks

- These notebooks are considered Job Exhibits for registration purposes at district and at state.
- There is no exhibit or project that accompanies this notebook to the state conference.
- You will drop off the notebook at district with the other job exhibit notebooks at district. At state there will be an area for notebooks to be placed for state judging.
- Be sure the proper score sheet with the registration sticker applied is the first page of the notebook. One for district and one for state.
- Only the notebook scoring rubric for each is used, this is not the same as the notebook score sheet for other job exhibits.
- These notebook options are available for High School and Middle School.
 - Automotive Advanced Service Technology Notebook
 - Employment Portfolio Notebook
 - Individual Member Notebook

Contents

INDIVIDUAL STUDENT NOTEBOOKS.....	1
AUTOMOTIVE ADVANCED SERVICE TECHNOLOGY NOTEBOOK	4
EMPLOYMENT PORTFOLIO NOTEBOOK.....	6
INDIVIDUAL MEMBER NOTEBOOK CONTEST	10
JOB EXHIBITS BEST OF SHOW	12
JOB EXHIBIT LIST.....	14
JOB EXHIBIT NOTEBOOKS.....	17
JOB EXHIBITS NOTEBOOK RATING SHEET-DISTRICT.....	19
JOB EXHIBIT PROJECT RATING SHEET-STATE.....	20
<i>2D / 3D Animation Short Film Job Exhibit</i>	<i>21</i>
<i>3D Animation - Technical Render Job Exhibit.....</i>	<i>23</i>
<i>Advertising Design Campaign Job Exhibit</i>	<i>25</i>
<i>Advertising Design Job Exhibit.....</i>	<i>27</i>
<i>Audio Production Job Exhibit.....</i>	<i>29</i>
<i>Automotive and Diesel Job Exhibits.....</i>	<i>31</i>
<i>Automotive Collision Repair Job Exhibits Project Rating Sheet-State.....</i>	<i>37</i>
<i>Automotive Collision Repair Custom Repair Project Rating Sheet-State</i>	<i>38</i>
<i>Cabinetmaking/Millwork Job Exhibit</i>	<i>39</i>
<i>Carpentry Job Exhibit</i>	<i>41</i>
<i>Commercial Baking – Baked Goods Job Exhibit</i>	<i>43</i>
<i>Commercial Baking – Showpiece Job Exhibit</i>	<i>45</i>
<i>Commercial Baking – 1-2 Tier Cakes Job Exhibit.....</i>	<i>47</i>
<i>Commercial Baking – 3-5 Tier Cakes Job Exhibit</i>	<i>49</i>
<i>Computer Maintenance Job Exhibit</i>	<i>51</i>
<i>Cosmetology Job Exhibits</i>	<i>53</i>
<i>Criminal Justice – Crime Scene Model Job Exhibit.....</i>	<i>63</i>
<i>Criminal Justice / Law Enforcement Display Panel Job Exhibit</i>	<i>65</i>
<i>Digital Illustration Job Exhibit.....</i>	<i>67</i>
<i>Digital Image Manipulation Job Exhibit</i>	<i>69</i>
<i>Drafting - Architectural Job Exhibit.....</i>	<i>71</i>
<i>Drafting – Technical Illustration Job Exhibit.....</i>	<i>77</i>
<i>Electrical Trades Job Exhibit</i>	<i>79</i>
<i>Electrical Trades Job Exhibit Project Rating Sheet-State.....</i>	<i>80</i>
<i>Electronic Design Job Exhibit Project Rating Sheet-State</i>	<i>81</i>
<i>Electronic Kit Job Exhibit Project Rating Sheet-State.....</i>	<i>82</i>
<i>Engineering Related Job Exhibit Project Rating Sheet-State.....</i>	<i>82</i>
<i>Fashion Design Job Exhibit.....</i>	<i>84</i>
<i>Health Sciences Display Panel Job Exhibit</i>	<i>90</i>
<i>Heating, Ventilation, AC, Refrigeration Job Exhibit Project Rating Sheet-State.....</i>	<i>92</i>
<i>Innovative Job Exhibits Project Rating Sheet-State.....</i>	<i>93</i>
<i>Interior Design Job Exhibit</i>	<i>94</i>
<i>Internetworking Job Exhibits</i>	<i>96</i>
<i>Internet of Things Job Exhibit</i>	<i>98</i>
<i>Landscape Horticulture Job Exhibit</i>	<i>100</i>
<i>Photo Panel Job Exhibit.....</i>	<i>103</i>
<i>Photography Job Exhibits.....</i>	<i>105</i>

<i>Plumbing Job Exhibit</i>	109
<i>Precision Machining Job Exhibit Project Rating Sheet-State</i>	111
<i>Restaurant Model-Culinary Job Exhibit</i>	112
<i>Video Production Job Exhibit</i>	114
<i>Web Page Design Job Exhibit</i>	116
<i>Welding Job Exhibits All Categories</i>	118

Automotive Advanced Service Technology Notebook

PURPOSE

The Notebook Contest is designed to encourage students to keep a notebook documenting and recording the diagnosing and repairing of vehicle systems using current industry standard information systems and procedures.

Drivability Issues, Engine Diagnosis, Fuel Systems, Emissions, ABS, ECM, Four Wheel Alignment, OBD or equivalent technology as well as industry standard repairs which are current occurrences in shops across the state today. Suspension repairs, disc and drum brake repairs, electrical system repairs and many others.

NOTE TO ADVISORS

Each Chapter advisor is encouraged to screen each member's notebook so those member notebooks submitted contains outstanding examples of material related to the Automotive Service Industry. These notebooks should demonstrate current automotive technology repair and service in alignment with current expectations of repairs being made in dealership and independent shop service departments. High School.

OBSERVER RULE

Notebooks shall be judged in the exhibit hall. Observers will not be allowed in the exhibit hall while notebooks are being judged. After the notebooks are judged, they will be on display for viewing.

RULES

All Job Exhibits Require a Notebook. Notebook description is found in this document titled Job Exhibit Notebook.

The project notebook should demonstrate core academic abilities. The student should demonstrate the use of proper English, Math, and Science in the project. Academics should be a major emphasis in the notebook. All text should be typed or computer generated. The use of preprinted materials such as Mitchell on Demand, All Data, or Manufacturer Service Manuals is allowed only as reference material of technical specifications or of specific repair procedures and **will not** replace the student narrative.

Automotive Service Technology Notebook Rating Sheet

Please place a copy of the rating sheet at the front of the report folder.

Contestant Number: _____

This contest is designed to allow students to document the knowledge and procedures used in their classes and labs on real life repairs and diagnostics. Trainers and live work are all part of their curriculum, this notebook is intended to allow students to demonstrate and document their ability to service the complicated systems on modern automobiles without having to produce the complete vehicle at contest.

All Job Exhibits Require a Notebook. Notebook description is found in this document titled Job Exhibit Notebook. The project notebook should demonstrate core academic abilities. The student should demonstrate the use of proper English, Math, and Science in the project. Academics should be a major emphasis in the notebook.

Judges will rate each of the following items in accordance with these ratings.

Judging Criteria	Points Allowed	Points Received
1. Does the notebook meet all of the requirements set forth in the rules?	100 Points	
2. Does the narrative adequately explain all steps taken in the proper order, with the proper documentation of specifications used?	0-40 Points	
3. Is the procedure documented typical of one found currently in the workplace?	0-20 Points	
4. Do the required photographs demonstrate the repair or diagnostics described, and are the proper safety precautions being demonstrated?	0-20 Points	
5. Does the notebook and its contents display the level of professionalism which should be expected of the student(s) involved?	0-20 Points	
	Total Score	

Score	DISTRICT	STATE
180 - 200	Qualified for State	Superior
160-179	Excellent	Excellent
140-159	Good	Very Good
Below 140	Honorable Mention	N/A

District or State Registration Sticker Should Be Placed Here

* If a notebook is rated less than qualified for state or superior, then judges should explain why below:

Employment Portfolio Notebook

Purpose: to evaluate contestants understanding of written employment procedures they will face when applying for positions in the occupational areas for which they are training. Notebooks should follow instructions found in the Rubric used to judge the portfolios.

Eligibility: Open to active SkillsUSA student members. Middle and High School

Observer Rule: Notebooks shall be judged in the exhibit hall or specified location. Observers will not be allowed in the exhibit hall or room while notebooks are being judged. After the notebooks are judged, they will be on display for viewing in the exhibit hall.

Equipment & Materials

- Supplied by the technical committee:
- All necessary information and furnishing for judges and technical committee to judge the notebooks.

Event Preparation

The following requirements must be included in the Employment Portfolios:

1. 3 ring, "one" inch notebook in red, black, or white is required. SkillsUSA notebooks are acceptable, no decorations.
2. Table of Contents is the first page of the notebook. It identifies all the documents as dictated by the syllabus and have been included in the notebook.
3. Description of current job, work, and or student activities being performed presently or in the past by the student should be included in the resume.
4. A job description is the advertisement/internet job posting or other documentation which describes the position, and the necessary skills required by the employer. This is critical for judges determining if the job seeker possesses the skill sets as required by the employer.
5. Key words in the student's resume, letter of application, letters of recommendation, and thank you letter should be consistent with the key words, phrases, and or elements discussed or requested in the job description. This is a critical requirement as many companies making hiring decisions use key word search of job seeker responses, (using computer application software), to reduce the about of time spent reading every line.
6. Each document submitted in the project notebook must demonstrate continuity of thought and work with other written documents contained in the notebook. The job seeker is advised to use the same stationary for all typed written letters and documents.
7. Students may use or quote other sources to support their leadership essay. Students using a source must give credit and acknowledge the source. If a student uses a source and does not give credit a score of "0" will be given.

Employment portfolios will be rated by skilled professionals on the guidelines discussed above and the criteria detailed below.

1. Neatness and readability - frankness, consistency, accuracy, initiative, ingenuity on the part of the job seeker.
2. Quality of written documents -correct and appropriate use of grammar, vocabulary, spelling, punctuation, sentence structure, document format and appearance.
3. Ability to express self in written form, convince and impress a new employer with regards to the standards of the occupation/job being sought – careful attention to detail, content, persuasiveness, and job seeker confidence.
4. Job seeker qualifications, education and occupational experiences, discretion, and tactfulness. Document demonstrates consistency and continuity with other documents in the portfolio.
5. Quality, effort, and originality. Portfolio documents and elements indicate considerable study, research, and effort expended in its development, construction, design, or arrangement.

Points awarded for each syllabus element on the rating sheet are divided by 5 and awarded based on achieving the above criteria. Example: Letter of Application has 10 available points. Using the above criteria, divide 10 points by 5 resulting in 2 points being allocated for each criterion stated above.

Employment Portfolio Notebook (cont.)

Employment Portfolio Rubric

Points awarded will be at the discretion of an experienced judge. One judge will determine the rating/score and write the rating on all sections of the entry card attached to the student exhibit. Judges are reminded to keep all information confidential until the exhibit hall is open for viewing and not to compare one exhibit/project with another. Rate each project individually without comparison of notebooks.

State Contest Guidelines

Comments/recommendations/feedback can be given on the back of score sheets to help contestants with future endeavors. However, it is recommended that the student submit an original and copy of their notebooks. (The copy may be placed behind the original marked as "For Judges Comments") This will allow the judge to make comments and suggestions that are applicable for each document without having to spend a great deal of time writing out explanations and leaves your original in pristine condition. Example – 2 (two) job seeker resumes... one that is the "Original" and the other is "For Judge's Comments". The Employment Portfolio notebooks will be evaluated using the contest Employment Portfolio Syllabus and Rating Sheet. Grade sheets from the district should be included in the notebook when presented at state.

1. **Binder:** - Black, red, or white 3 ring, "one" inch binder. SkillsUSA notebooks are also acceptable. No decorations.
2. **Title Page:** As described in the syllabus
3. **Table of Contents:** Is the first page of the notebook. It identifies all the documents as dictated by the syllabus and included in the notebook.
4. **Resume:** The job seeker should convey their qualifications, work and or classroom experiences for the desired job by highlighting strengths, accomplishments, and responsibilities that demonstrate their ability to perform. The resume is to contain a clearly stated job objective which supports or applies to the job sought. It should speak to the job as described in the **Job Description** (see below) as required by the syllabus. The resume should be pleasing to the eye as to capture the interviewer's interest with its layout and easy readability. The resume may contain the following – job objective, educational background, work experiences/skills, special experiences, activities, honors, and references. Careful attention to content is expected.
5. **Request Letters of Recommendation** – Letters ask specifically for a recommendation "letter" to be completed by a specified date. For consistency, the recommendation providers should be the same as those indicated in the job seeker's resume. These letters are formal requests and contain an address line, (contact information of the job seeker), date, greeting, and opening, reason for the letter, body, closing, salutation, and signature. The request should ask the provider to speak to the job seeker's performance, specific skills sets, and or accomplishments and be consistent with the job seeker's resume. Careful attention to content & detail is expected.
6. **Letter requesting a letter of Recommendation (max of three):** These are formal letters. It is recommended that these letters contain an address line, (contact information of the respondent), date, greeting, and opening with a reason for the letter, body (name job seeker who is the subject of the recommendation letter), closing, salutation and signature. It is recommended that the letter of recommendation address the employer specifically. For letters of recommendation to be effective, they should address the employer by name and title instead of "To whom it may concern". The body of the letter should state the relationship of the respondent to the job seeker. Letters will be judged on neatness, readability, content, and consistency in complying with specifics asked for in "Request Letters of Recommendation" above. Letters of recommendation must come from individuals who actually know the job applicant. Judges want letters from those who were requested to write a letter or where given as a reference on the applicant's resume and supports continuity with the other syllabus documents. Letters of recommendation should speak to the job seeker's skills, accomplishments, and responsibilities and be consistent with the job seeker's resume. The letter of recommendation should add value to the job seeker's portfolio, not detract from it. Letters of acceptance from a college are commendable, may be included, but cannot be considered as one of the three required letters. Why...because a college/university does not know the job seeker personally and cannot make recommendation in employment situations. Use of college acceptance letter for the required letter of recommendation is cause for point deduction. Care should be taken when deciding which letter of recommendation, a student uses in their portfolio. Although the student does not produce the letter, it is advisable to use only those letters which exemplifies professionalism and leadership. No matter how readable, neat and well formatted a letter may be a poorly written letter should never be used in the portfolio for competition or in the real world. The objective of this contest is to prepare job seeker/students for the expectations of hiring decision makers in this new millennium. We recognize that the student cannot control what is written by someone else. However, the bottom line is if a recommendation letter is not carefully written, it can cause the job seeker/student un-recoverable harm in their job seeking process and should not be used. Total points may not be received for poorly written letters that are used in the portfolio.
7. **High School Transcript:** An "official high school transcript" is required. It contains specifics as to honor and general courses taken by the job seeker, final grades and test scores achieved, the embossed high school seal, recommend or distinguished diploma track, and TAKS achievement ratings, SAT or ACT scores are also indicated. Other pertinent information is usually included on the back of transcripts. Example – student's health or shot record.

Employment Portfolio Notebook (cont.)

8. **Leadership Essay:** The job seeker speaks to the elements of leadership and its impact on themselves and others. The essay is a composition devised by the student and is relevant to the job seeker/student as they prepare for the writing requirements of the job and writing portions of college entrance exams such as THEA, SAT, ACT or Accuplacer. Careful attention to content is expected. Student must give source credit for any reference material or quotes used. If a student uses a source in their essay and does not give credit, score of "0" will be given.
9. **Job Description:** This is a description of the job that the applicant seeks. It can be the ad from the newspaper or Internet, retyped of course for presentation in the portfolio. This should not be the description of the job the job seeker currently holds. The student should provide their current job information in their resume. The job description is the document used by judges to determine if the job seeker's resume and other support materials/documents included in the portfolio qualifies, meets the requirements and expectations of the interviewer/employer. Consistency and continuity with other documents in the job seeker's portfolio is expected.
10. **Letter of Application:** This is commonly referred to as a "cover letter" for the job seeker's resume. This is a formal document in the job seeker's arsenal to explain their reason for contacting the company or individual, expresses interest, and maintains consistency with the job seeker's resume. The letter refers to the ad and the position sought or the insider source providing the information about the job opening. The cover letter may highlight an important aspect of the applicant's background, include information that does not necessarily appear in the resume, ask specifically for the opportunity to interview, and ask for a timely response. The letter should be typed and use the same stationary as the resume. It should contain an address line, date, subject line, greeting, and opening, with a reason for the letter, body, closing, salutation, and signature. Careful attention to detail and content is expected.
11. **Thank You Letter (follow-up letter):** This is a formal letter and expresses the job seeker's appreciation and interest in the position and addresses the interviewer/employer by name. It contains an address line, date, subject line, greeting, and opening, a reason for the letter, body, closing, salutation, and signature. It must contain the interviewer's/employer's name and applicant's signature. The job seeker has a small amount of space to get the interviewer's attention. This is where the job seeker uses what was learned in the interview and makes use of it to write, "sales copy" highlighting qualifications, assets, accomplishments, and or convincingly describes how they can benefit the employer. All those words said during the interview are dwindling down to one or two remarks; the job seeker's image is fading fast and is competing with others for the position. Content should be created carefully. This is the one letter in the portfolio that can be submitted in the contestant's own handwriting. This is because in the real world, the handwritten thank you letter with envelop stands out above the pile of mail or e-mail that decision makers receive daily.
12. **Letter of Acceptance from job seeker:** This letter demonstrates the job seeker's confidence in their decision to accept the job opportunity as offered by the interviewer/employer. This is where the job seeker may say they are anticipating an opportunity to contribute. This is a formal letter and should contain an address line, date, subject line, greeting, and opening, reason for the letter, body, closing, salutation, and signature with careful attention to content. It must contain the interviewer's name and job seeker's signature. Careful attention to content is expected.
13. **Letter of Regret from job seeker:** This letter demonstrates the job seeker's confidence in their decision "not" to accept the job as offered by the interviewer/employer. This is where the applicant says in writing that they have made another decision and why. Their reason should be short, use action words, be specific, and maintains continuity with the other documents contained in the portfolio. This is a formal letter and should contain an address line, date, subject line, greeting, and opening, reason for the letter, body, closing, salutation, and signature. It must contain the interviewer/employer's name and job seeker's signature. Careful attention to content is expected.
14. **Certificates, Awards, newspaper articles of job seeker:** These are considered icing on the cake and should support the job seeker's accomplishments, responsibilities, skills set, and goals achieved and be consistent with resume and other elements of the portfolio. Certificates may be placed in sheet protectors.

Reference Materials: This list of references is not intended to be inclusive. Other sources may be utilized and educators are encouraged to make use of the very best instructional materials available. The following list contains references that may prove helpful during event preparation.

- "The Quick Reference Resume & Cover Letter Book" – Second Edition by J. Michael Farr ISBN 1-56370-634-2
- "The Career Tool Kit for High School Students Making the Transition from School to Work" by Carol Carter, Gary Isumo, Sarah Lyman Kravets, Diane Liadsey Reeves ISBN 0-13-08847-0
- "The Gregg Reference Manual" by William A. Sabin ISBN 0-02-804047-3
- "Cover Letters that Knock 'em Dead" by Martin Yate ISBN 1-58062-793-5
- "Resumes that Knock 'em Dead" by Martin Yate ISBN 1-55850-955-0
- "The Complete Job Interview Handbook" by John J. Marcus ISBN 0-06-273266-8
- "Now, Discover Your Strengths" by Marcus Buckingham & Donald O Clifton PHD ISBN 0-7432-0114-0
- "The Elements of Style", Third Edition by William Strunk Jr. and E. B. White ISBN 0-02-418230-3
- "25 Reasons Why I Won't Hire You" by Zenja Glass ISBN 0-9667452-0-5
- "Resumes for Dummies" by Joyce Lain Kennedy ISBN 0-7645-5226-0
- "The Resume" by Jeff Allen ISBN 0-471-52536-7
- "Get the Interview" by Jeff Allen ISBN 0-471-52546-4
- "Win the Job" by Jeff Allen ISBN 0471-52551-0
- Microsoft Word Professional Office Templates

Employment Portfolio Notebook Rating Sheet

Please place a copy of the rating sheet at the front of the report folder.

Contestant		
Topic	Points Available	Points Received
Binder – Black	5	
Title Page includes (total of 5 points)	5	
“Employment Portfolio” -1 point		
Student’s Name -1 point		
Name of occupation -1 point		
Chapter Number -1 point		
1 st or 2 nd year student -1 point		
Resume (Include three references on second page)	50	
Letter Requesting Letters of Recommendations	20	
1. Letter of Recommendation	10	
2. Letter of Recommendation	10	
3. Letter of Recommendation	10	
High School Transcript	10	
SkillsUSA Leadership Essay	10	
Job Description	10	
Letter of Application	10	
Thank You Letter (follow-up letter)	10	
Letter of Acceptance	10	
Letter of Regret	10	
Certificates, Awards since the 9 th grade	10	
Overall Appearance	10	
Total Points	200	

Score	DISTRICT	STATE
180 - 200	Qualified for State	Superior
160-179	Excellent	Excellent
140-159	Good	Very Good
Below 140	Honorable Mention	N/A

**District or State Registration
Sticker Should Be Placed Here**

* If a notebook is rated less than qualified for state or superior, then judges should explain why below:

Comments:

Individual Member Notebook Contest

PURPOSE

The Notebook Contest is designed to encourage students to keep a notebook containing items of technical information related to the trade they are learning. Notebooks will be complete with questions answered by the students in their own handwriting.

NOTE TO ADVISORS

Each chapter advisor is encouraged to screen each member's notebook so that member notebooks submitted contains **outstanding** examples of written material related to their Career and Technical Education. Middle and High School.

OBSERVER RULE

Notebooks shall be judged in the exhibit hall. Observers will not be allowed in the exhibit hall while notebooks are being judged. After the notebooks are judged, they will be on display for viewing.

RULES

1. Notebooks to be bound in regular two (2) or three (3) ring notebook covers.
(Plain covers or official notebooks only)
2. Lined loose-leaf notebook paper must be used for all written work and unlined paper or graph paper for drawings. (Plastic fillers may be used for preserving drawings only.)
3. Notebooks must contain the following in this order:
 - a. Individual Note Book Grade Sheet
 - b. Cover Sheet
 - i. Student's name
 - ii. Name of occupation
 - iii. Chapter number
 - iv. 1st or 2nd year student
 - c. Table of contents
 - i. Title of related assignments
 - ii. Page number of assignments in notebook
 - d. Preface or Introduction Body
 - e. Bibliography-Sources of all material used in notebook.
 - f. Student Resume
4. All pages in notebook must be numbered and correspond with numbers in the table of contents.
5. Grades and error marking of teachers must appear on written assignments. (Teachers should carefully check each page of the notebook.)
6. All written assignments are to be written in student's handwriting as prepared in class. DO NOT TYPE ASSIGNMENTS.
7. Notebooks rated "State Qualified" at District may advance to State meeting.

Individual Member Notebook Rating Sheet

Please place a copy of the rating sheet at the front of the report folder.

Contestant Number: _____

The judges will rate each notebook in accordance with the following ratings, considering the points indicated.

Judging Criteria	Possible Points	Points Awarded
The notebook shows originality and initiative on the part of the student	0-30 points	
The notebook contains handwritten information, sketches, drawings, diagrams and printed material directly related to the trade the student is learning, and typical of what should be taught in a related theory class in this occupation for the length of time the student has received training	0-80 points	
Notebooks to be bound in Plain Cover or Official notebook. Lined loose-leaf notebook paper to be used. Plastic fillers may be used for preserving drawings ONLY.	0- 10 points	
Cover sheet-name of student's name, occupation, chapter number, 1st or 2nd year student.	0- 10 points	
Table of Contents. a. Title of related study assignment b. Page number of assignments in notebook	0- 10 points	
Preface or Introduction	0- 10 points	
Sources of pictures and cutout periodicals used in notebook.	0- 10 points	
Bibliography.	0- 10 points	
All pages must be numbered and correspond to table of contents	0- 10 points	
Grades and error marking of teacher must appear on written assignments.	0- 10 points	
Student Resume	10 Points	
TOTAL SCORE	100 Points	

Comments: _____

Score	DISTRICT	STATE
180 - 200	Qualified for State	Superior
160-179	Excellent	Excellent
140-159	Good	Very Good
Below 140	Honorable Mention	N/A

**District or State Registration
Sticker Should Be Placed Here**

JOB EXHIBITS BEST OF SHOW

Job Exhibit Best of Show Guidelines

PURPOSE

- Best of Show is only awarded at the State level. Job exhibits must be present, at the state conference to be considered for Best of Show awards.
- Job exhibits with superior ratings from the state conference are considered for Best of Show.
- Best of Show Divisions may include an individual and/or group job exhibit indicated in the categories below. (Individual and group categories awarded at the judge's discretion)
- There will be no Best of Show Awards for the Student Notebook or Photo Panel Categories.

JUDGING CRITERIA

1. Objective of the exhibit.
2. Amount of time needed to achieve the objective.
3. Complexity of the exhibit.
4. Uniqueness of the exhibit
5. Craftsmanship demonstrated.
6. Documentation in the exhibit notebook.

Best of show or overall best of show awards may not be given in all categories if judges determine none meets the criteria.

Overall Best of Show Awards

One (1) Overall Best of Show will be chosen from each of the CTE Career Clusters eligible to participate in SkillsUSA Texas. Job Exhibits must be present at the state conference to be considered for an Overall Best of Show award. The winner will be announced at the closing awards ceremony.

All Best of Show and Overall Best of Show Committee decisions are final. There will be no appeal or grievance allowed. Written suggestions should be given to the Teacher Advisory Committee.

Overall Best of Show Clusters

Architecture & Construction
Arts, A/V Technology and Communications
Hospitality & Tourism
Human Services
Information Technology
Law, Public Safety Corrections & Security
Manufacturing
Science, Technology, Engineering & Mathematics
Transportation Distribution & Logistics

Best of Show Cluster and Categories

Architecture & Construction	Human Services (cont.)
Drafting Architectural Modeling	Cosmetology Salon
Civil Engineering	Cosmetology Flat Nail Art
General Carpentry	Cosmetology Nail Art 3D
Finished Woodwork	Cosmo Women's Edge Cut/Color
CAD - Architectural Drafting	Fashion Design
CAD - Technical Drafting	Health Sciences Display Panel
Commercial Wiring	Interior Design
Electrical Trades	Information Technology
HVACR	Computer Maintenance Technology
Innovative Architecture & Construction	Internet of Things
Plumbing	Innovative Information Technology
Technical Drafting	Internetworking
Arts, A/V Technology & Communications	Web Page Design
Audio Radio Production	Law, Public Safety, Corrections & Security
Advertising Design	Criminal Justice Crime Scene Model
Animation 2D/3D Short Film	Criminal Justice Display Panel
3D Animation Technical Rendering	Innovative Law, Public Safety Corrections & Security
Digital Illustrations	Manufacturing
Graphics Communications Offset	Innovative Manufacturing
Graphic Communications Digital	Precision Machining
Innovative Arts, A/V Technology and Communications	Welding Furniture
Photography General	Welding General
Photography Commercial	Welding Pits
Photography Portrait	Welding Trailers
TV (Video) Production	Science, Technology, Engineering & Mathematics
Hospitality & Tourism	Electronic Kit
Commercial Baking Showpieces	Innovative STEM
Commercial Baking Innovative	Engineering Related Design
Commercial Baking 1-2 Tiered Cakes	Transportation Distribution & Logistics
Innovative Hospitality & Tourism	Auto Service Technology
Restaurant Model	Automotive Single Engine
Human Services	Collision Repair Tech and Custom
Cosmo Braiding and Hair Extensions	Diesel Equipment Tech
Cosmo Day Evening Hair Design	Innovative Transportation Distribution & Logistics
Cosmetology Fantasy	Motorcycle Technology
Cosmetology Innovative	Power Equipment Technology
Cosmetology Men's Classic Cut	Motorcycle Technology
Cosmetology Men's Cutting Edge Cut	
Cosmetology Innovative	

JOB EXHIBIT LIST

Job Exhibit Name	Categories	Grading Sheet	Best of Show Category
2D/3D Animation Short Film	Ind, Mult, Chap	Specific	Arts, A/V Tech & Comm
3D Animation	Ind, Mult, Chap	Specific	Arts, A/V Tech & Comm
Advertising Design Campaign	Ind, Mult	Specific	Arts, A/V Tech & Comm
Advertising Design	Ind	Specific	
Audio Production	Ind, Mult	Specific	Arts, A/V Tech & Comm
Auto Automatic Transmissions Trans Axle	Ind, Mult, Chap	Auto/Diesel General	
Auto Brake Components	Ind	Auto/Diesel General	
Auto Collision Repair Custom	Ind, Mult, Chap	Specific	Transp, Dist & Logistics
Auto Collision Repair Tech	Ind, Mult, Chap	Specific	Transp, Dist & Logistics
Auto Cylinder Head	Ind, Mult	Auto/Diesel General	
Auto Diesel Components	Ind, Mult, Chap	Auto/Diesel General	Transp, Dist & Logistics
Auto Electrical Components	Ind, Mult, Chap	Auto/Diesel General	
Auto Engine Long Blocks	Ind, Mult, Chap	Auto/Diesel General	
Auto Engine Short Blocks	Ind, Mult, Chap	Auto/Diesel General	
Auto Manual Transmission Trans Axles	Ind, Mult, Chap	Auto/Diesel General	
Auto Rear Wheel Drive Differential	Ind, Mult, Chap	Auto/Diesel General	
Auto Service Technology	Ind, Mult, Chap	Auto/Diesel General	Transp, Dist & Logistics
Auto Single Engine	Ind, Mult, Chap	Specific	Transp, Dist & Logistics
Aviation Maintenance Technology	Ind, Mult, Chap	Generic	
Cabinetmaking and Millwork	Ind, Mult, Chap	Generic	Arch & Construction
Carpentry Project	Ind, Mult, Chap	Carpentry General	Arch & Construction
CJ Crime Scene Model	Ind, Mult	Specific	Law, PS, Corr & Sec
CJ Display Panel	Ind, Mult	Specific	Law, PS, Corr & Sec
Commercial Baking	Ind	Specific	
Commercial Baking 1-2 Tier	Ind	Specific	Hospitality & Tourism
Commercial Baking 3-5 Tier	Ind, Mult	Specific	Hospitality & Tourism
Commercial Baking Showpiece	Ind, Mult	Specific	Hospitality & Tourism
Computer Maintenance Technology	Ind, Mult	Specific	Information Technology
Cosmo 3D Nail Art	Ind	Specific	Human Services
Cosmo Braiding	Ind	Specific	Human Services
Cosmo Day or Evening	Ind	Specific	Human Services
Cosmo Fantasy	Ind	Specific	Human Services
Cosmo Flat Nail Art	Ind	Specific	Human Services
Cosmo Men's Classic	Ind	Specific	Human Services
Cosmo Men's Cutting Edge	Ind	Specific	Human Services
Cosmo Salon	Ind, Mult	Specific	Human Services
Cosmo Women's Cutting Edge	Ind	Specific	Human Services
Culinary Project	Ind	Specific	
Diesel Equipment Tech	Ind, Mult, Chap	Auto/Diesel General	Transp, Dist & Logistics
Digital Illustration	Ind	Specific	Arts, A/V Tech & Comm
Digital Image Manipulation	Ind	Specific	Arts, A/V Tech & Comm
Drafting Architectural Modeling	Ind, Mult, Chap	Specific	Architect & Construction
Drafting CAD Architectural Project	Ind, Mult	Specific	Architect & Construction

Job Exhibit Name	Categories	Grading Sheet	Best of Show Category
Drafting CAD Technical	Ind, Mult	Specific	Architect & Construction
Drafting Civil Engineering	Ind	Specific	Architect & Construction
Drafting Technical Illustration	Ind, Mult	Specific	Architect & Construction
Electrical Trades	Ind, Mult, Chap	Specific	Architect & Construction
Electronic Design	Ind, Mult	Specific	STEM
Electronic Kit Project	Ind, Mult	Specific	
Employment Portfolio (MS and HS)	Ind	Specific	
Engineering Related Design Exhibit	Ind, Mult, Chap	Specific	STEM
Fashion Design	Ind, Mult, Chap	Specific	Human Services
Graphic Communications Digital Exhibit	Ind, Mult	Specific	Arts, A/V Tech & Comm
Graphic Communications Offset Exhibit	Ind, Mult	Specific	Arts, A/V Tech & Comm
Health Sciences Display Panel	Ind, Mult	Specific	Human Services
Heating, Ventilation, AC, Refrigeration	Ind, Mult, Chap	Generic	Architect & Construction
Individual Member Notebook (MS and HS)	Ind	Specific	
Innovative Architecture & Construction	Ind, Mult, Chap	Innovative General	Architect & Construction
Innovative Arts A-V Tech & Communication	Ind, Mult, Chap	Innovative General	Arts, A/V Tech & Comm
Innovative Cosmetology	Ind, Mult, Chap	Innovative General	Human Services
Innovative Hospitality & Tourism	Ind, Mult, Chap	Innovative General	Hospitality & Tourism
Innovative Information Tech	Ind, Mult, Chap	Innovative General	Information Technology
Innovative Law Public Safety & Correction	Ind, Mult, Chap	Innovative General	Law, PS, Corr & Sec
Innovative Manufacturing	Ind, Mult, Chap	Innovative General	Manufacturing
Innovative STEM	Ind, Mult, Chap	Innovative General	STEM
Innovative Tran Distribution & Logistics	Ind, Mult, Chap	Innovative General	Transp, Dist & Logistics
Interior Design	Ind, Mult, Chap	Specific	Human Services
Internet of Things	Ind, Mult, Chap	Specific	Information Technology
Internetworking	Ind, Mult, Chap	Specific	Information Technology
JOB EXHIBIT MIDDLE SCHOOL	Ind, Mult, Chap	Generic	
Job Exhibit Other	Ind, Mult, Chap	Generic	
Landscape Horticulture	Ind, Mult	Specific	
Motorcycle Service Technology	Ind, Mult, Chap	Specific	Transp, Dist & Logistics
Photo Panel (MS and HS)	Ind	Specific	
Photo Commercial	Ind, Mult	Specific	Arts, A/V Tech & Comm
Photo General	Ind	Specific	Arts, A/V Tech & Comm
Photo Portrait	Ind	Specific	Arts, A/V Tech & Comm
Plumbing	Ind, Mult, Chap	Generic	Architect & Construction
Power Equip Technology	Ind, Mult, Chap	Specific	Transp, Dist & Logistics
Precision Mach Technology	Ind, Mult, Chap	Specific	Manufacturing
Restaurant Model	Ind, Mult	Specific	Hospitality & Tourism
TV Video Production	Ind, Mult	Specific	Arts, A/V Tech & Comm
Web Page Design	Ind	Specific	Information Technology
Welding Furniture	Ind, Mult, Chap	Welding General	Manufacturing
Welding General	Ind, Mult, Chap	Welding General	Manufacturing
Welding Pits	Ind, Mult, Chap	Welding General	Manufacturing
Welding Trailers	Ind, Mult, Chap	Welding General	Manufacturing

Categories:

Individual – 1 member per notebook

Multiple – 2 to 5 members per notebook

Chapter – 6 to 50 members per notebook

Grading Sheets:

If the table states “specific” please go to that job exhibit in this document and print the specific rating sheet. You will need a notebook grading sheet and specific grading sheet.

If the table states “generic” please go to the generic job exhibit rating sheet and print that for the notebook. The generic grading sheet includes the notebook scoring.

Please include a blank grading sheet for district and if the exhibit advances to state, please leave the district notebook grading sheet in the notebook from district and include a blank copy of project judging sheet for state judges. The notebook portion will not be judged again at state so only include the specific sheet for that exhibit for state.

The registration stickers for district and state should be placed on the grading sheet not the outside of the notebook.

Best of Show Category:

If there is not one listed that job exhibit does not qualify for a Best of Show category.

JOB EXHIBIT NOTEBOOKS

Job Exhibits are designed to allow students to document the real-world knowledge, procedures and job skills used in their programs. Trainers and live work are all part of the curriculum; therefore, this notebook is intended to allow students to demonstrate and document their ability to perform trade specific skills within their program. The notebook is calculated as a 200-point value of each job exhibit total rating. This notebook is required for all job exhibits. The Notebook only is judged at the district level. The qualifying notebook and project are judged in person at state.

RULES

1. All text is typed or computer generated. The use of preprinted materials such as manuals or course textbook is allowed only as reference material of technical specifications or of procedures and **will not** replace the student narrative.
2. Job Exhibit Notebook for multiple and chapter entries:
 - a. One Notebook for the job exhibit
 - b. Must contain a resume for all members of the team
3. For all Job Exhibit Notebook, must contain the following in this order:
 - a. Job Exhibit Notebook Grade Sheet (district) with registration sticker attached
 - b. Job Exhibit Project Grade Sheet (state) with registration sticker attached
 - c. Cover Sheet:
 - i. Student's name (if Multiple or chapter include the other team members)
 - ii. School Name
 - iii. Course enrollment
 - iv. 1st or 2nd year student
 - v. Chapter number
 - vi. Four pictures minimum, 2"x3", of **completed** project from Multiple angles, including close ups of any important details.
 - vii. One image 4x6 of the student and the completed project. This image will also be uploaded to a drive after registration closes. Must be a JPG or PNG of printing resolution. Instructions for upload will be provided with registration.
 - d. Resume (If a group or Multiple project - each student must have resume.)
 - e. Preface or Introduction: Why chose this job exhibit category. Brief education recap for program studies. Any significance of purpose for the exhibit or value. Quality of writing - correct use of grammar, spelling, vocabulary, document format, project quality, effort, and originality are all factors that will be considered in notebook scoring.
 - a. Body of notebook – project description Student(s) narrative of task (if a group each student should have their own narrative).
 - b. Detailed descriptions of work. Pre-planning/Brainstorming, Design/Construction, Testing/problems that changed plan, final result.
 - c. Step by step list of tasks performed. Students should include detailed step-by-step description that contains charts and diagrams explaining work performed, specifications, tests, safety considerations, and results.
 - d. Drawings, sketches, schematics, measurements, etc.
 - e. List of parts, ingredients, products, etc.
 - f. Tool/Implementation/Equipment/Software List
 - g. Material List (with receipts) or if donated list of items (acknowledge donator)
 - h. Student Work photos - a minimum of six photographs 2"x3" showing the student(s) involvement in each aspect or phase of the job completion. These photos should be time and date stamped, taken from Multiple angles and proximity highlighting quality of work. Photos should depict critical steps and proper safety procedures. Student should be in all of the photos with the work. If a team submission each team member should have at least one photo with the project.

- i. Bibliography – Sources of all material, including electronic, used in notebook.
2. Notebook can be a 1” 3 ring binder with clear cover sleeve or Report cover w brads with clear cover.
3. Must register for district and state as either a contestant – student is coming to the conference with the notebook/project or as a member only, student is not attending the conference but a school representative is bringing the notebook/project for judging. If the student is not attending the job exhibit will not be eligible for Best of Show awards at state.
4. Job Exhibit participation is limited to one individual entry per person; only one exhibit and/or one individual notebook may be entered per person. In addition, if a student is part of a Multiple or chapter job exhibit that student may add only one Multiple **or** one-chapter exhibit but not both. Exhibits may be produced as the following:
 - a. Individual job exhibits one per student
 - b. Multiple Job Exhibit – 2 to 5 students.
 - c. Chapter Job Exhibit – 6 or more students up to # of members in a chapter.
5. Grievances may be reviewed by a specified deadline. Reasons that will be considered for grievances for job exhibit notebooks are as follows:
 - a. Mathematical error
 - b. Job Exhibit not judged

JOB EXHIBITS NOTEBOOK RATING SHEET-DISTRICT

- *The 1st document in the notebook at district should be this rating sheet.*
- *The 2nd document in notebook should be the scoring rules for the project.*
- *The district registration sticker must be affixed to this page to be judged at district.*
- *The district qualified stamp must be present on this page in the notebook to advance to state.*
- *This sheet with district registration sticker, judges scores, and qualified stamp must be in the notebook if registered at state in order for the 200 points to be added to the project score at state.*

Judging Baseline Criteria for Notebooks 200 points	Points Allowed	Points Received
1. Does the notebook meet all of the following requirements set forth in the rules:		
a. Cover Sheet	5	
b. Table of Contents	5	
c. Resume (s) if a group project	5	
d. Preface or Introduction	5	
e. Body	5	
f. Tool/Implement List	5	
g. Material List	5	
h. Timeline Photographs/Documentation	5	
i. Bibliography - *Citation of royalty free content (if used)	5	
j. Completed Project Documentation	5	
2. Does the notebook describe job, occupation, or skills accurately?	30	
3. Does the project accurately meet the specifications or description submitted and does it have adequate evidence of the work performed?	20	
4. Does the project meet the standards of the occupation for quality, finish, neatness, pleasing in appearance? See the project rules for guidance.	20	
5. Does the project indicate that considerable study and effort that was expended in its design (if applicable), construction, assembly and/or arrangement?	10	
6. Does the narrative adequately explain all steps taken in the proper order, with the proper documentation of specifications used?	20	
7. Is the procedure documented typical of one found currently in the workplace?	5	
8. Do the required photographs demonstrate the specific skill, and are the proper safety precautions being demonstrated? Do they show the quality of work described in the project rules?	15	
9. Does the notebook and its contents display the level of professionalism which should be expected of the student(s) involved?	15	
10. Does the project show originality and initiative on the part of the student. Does it reflect work that should advance to state competition?	15	
Notebook total maximum score 200	200	

Notebook Grade Only

Score	DISTRICT Judging
180 - 200	Qualified for State
160-179	Excellent
140-159	Very Good
Below 140	Honorable Mention

**District Registration Sticker
Should Be Placed Here**

JOB EXHIBIT PROJECT RATING SHEET-STATE

- This rating sheet for judging the job exhibit project at state and is to be used ONLY if there is NOT a specific rating sheet. This is the rating sheet for all Middle School Job Exhibits. The completed Job Exhibit Notebook Rating Sheet, from district judging, must also be in the notebook to be judged at the state level.

Judging Baseline Criteria for Notebooks & Projects 400 points	Points Allowed	Points Received
1. Does the notebook meet all of the requirements set forth in the rules? <i>Enter the score from the District Job Exhibit Notebook Rating Sheet</i>	0-200	
2. Does the project accurately meet the specifications or description submitted and does it have adequate evidence of the work performed?	0-30	
3. Does the project meet the standards of the occupation for quality, finish, neatness, pleasing in appearance?	0-30	
4. Does the project indicate that considerable study and effort that was expended in its design (if applicable), construction, assembly and/or arrangement?	0-30	
5. Does the narrative adequately explain all steps taken in the proper order, with the proper documentation of specifications used?	0-20	
6. Is the procedure documented typical of one found currently in the workplace?	0-20	
7. Do the required photographs demonstrate the specific skill, and are the proper safety precautions being demonstrated?	0-20	
8. Does the notebook and its contents display the level of professionalism which should be expected of the student(s) involved?	0-20	
9. Does the project show originality and initiative on the part of the student	0-30	
400 Points Possible	Total Score	
Judges Remarks		

Score	
360 - 400	Superior
320 – 359	Excellent
280 – 319	Very Good
0 - 279	N/A

**State Registration Sticker Should
Be Placed Here**

2D / 3D Animation Short Film Job Exhibit

Purpose

A 2D/3D Animation Short Film job exhibit is a short film that highlights student's creative and technical abilities in animation, including but not limited to digital, hand-drawn, stop motion, Claymation, cutout.

THIS DOCUMENT SHOULD BE THE 2nd ITEM IN YOUR NOTEBOOK AT DISTRICT

Specifications

- Entries must be started and completed during the current school year, beginning no earlier than August 1st.
- Entries can be by an individual, group (2-5), or chapter (6+)
- All content, including music, must be original OR royalty free. *
- Entry must be 3 minutes or less (not including pre-program).
- Each exhibit must include a notebook secured in a binder or folder.

Principles of Animation

- The basic principles of animation should be considered and applied to all entries. Squash & Stretch
- Anticipation
- Staging
- Straight ahead action & Pose to pose
- Follow through & Overlapping action
- Slow in & Slow out
- Arc
- Secondary Action
- Timing
- Exaggeration
- Solid Drawing
- Appeal

All Job Exhibits Require a Notebook. Notebook description is found in this document titled Job Exhibit Notebook. The project notebook should demonstrate core academic abilities. The student should demonstrate the use of proper English, Math, and Science in the project. Academics should be a major emphasis in the notebook. Be sure to include in the body of this notebook:

- a. Body of notebook if 2D
 - i. Conceptualization
 - ii. Modeling
 - iii. Texturing
 - iv. Lighting
 - v. Rendering
- b. Body of notebook if 3D
 - i. Conceptualization
 - ii. Storyboarding
 - iii. Character Development
 - iv. Problems and Solutions

2D/3D Animation - Short Film Job Exhibit Project Rating Sheet-State

Please place a copy of the rating sheet for each project entry at the front of the report folder.

The completed district notebook grading sheet with registration sticker and state qualifying stamp should be included in the notebook for state submission with the project. This rating sheet is for the project only at state which will be added to the district notebook grade.

The judges will judge each entry using the following criteria, along with their own knowledge of professional animation.

JUDGING CRITERIA		Max. Points	Points Awarded
1	Pre-Program: 5 seconds black, 5 seconds slate (ch. number, contestant name, run time), 2 seconds black	30	
2	Visual: Framing, Movement, Depth, Angles, Lighting, Graphics	30	
3	Audio: Levels, Mixing, Use of Music/Effects, Lack of Distortion/Noise* (if no audio is present please mark 20* do NOT count off for absence of sound)	20	
4	Modeling: Quality, Clean Edges, Complexity of Model	30	
5	Texturing: Complexity of Textures; is the depth apparent and appropriate? Does the shading/specular match the subject?	30	
6	Editing: Shot Selection, Variety, Pacing, Use of Effective Editing Techniques	30	
7	Interpretation and Complexity: Artistic ability, overall appeal with regard to animations of equal education and experience, with clear message or objective	30	
8	Documentation (Notebook/Folder): Enter Score from Job Exhibit Notebook Rating Sheet	200	
Total Points		400	
PENALTIES			
1	Copyrighted Material: All content must be original OR royalty free	-20	
2	Time Penalty: All videos must be 3 minutes or less.	-10	
Total Penalties		-30	
Note to Judges: If an exhibit is rated less than qualified for state or superior, the judges should explain why in the remarks section below.		TOTAL SCORE	
Judges Remarks:			

Score	
360 - 400	Superior
320 – 359	Excellent
280 – 319	Very Good
0 - 279	N/A

State Registration Sticker Should Be Placed Here

3D Animation - Technical Render Job Exhibit

Purpose

An Animation Technical Render job exhibit is a rendered frame that highlights student's creative and technical abilities in animation.

Specifications

- Entries must be started and completed during the current school year, beginning no earlier than August 1st.
- Entries can be by an individual, group (2-5), or chapter (6+)
- All content must be original
- Each exhibit must include a notebook

THIS DOCUMENT SHOULD BE THE 2nd ITEM IN YOUR NOTEBOOK AT DISTRICT

12 Principles of Animation

Each entry should consider and apply the basic principles of animation.

Squash & Stretch

- Anticipation
- Staging
- Straight ahead action & Pose to pose
- Follow through & Overlapping action
- Slow in & Slow out
- Arc
- Secondary Action
- Timing
- Exaggeration
- Solid Drawing
- Appeal

Elements & Principles of Design

Each entry should consider and apply basic elements and principles of design, including any of the following:

- Elements: line, shape, color, texture, pattern, value, form
- Principles: contrast, alignment, repetition, proximity, balance, unity, emphasis, rhythm, and proportion

Dimensions

Each submission or print may fill a space no larger than 2' x 2' x 3' when displayed, including matting and display stands.

Notebook – see all job exhibit notebook specification sheet for more detail

All Job Exhibits Require a Notebook. Notebook description is found in this document titled Job Exhibit Notebook. The project notebook should demonstrate core academic abilities. The student should demonstrate the use of proper English, Math, and Science in the project. Academics should be a major emphasis in the notebook. Be sure to include the following in the body of the notebook included:

- v. Conceptualization
- vi. Modeling
- vii. Texturing
- viii. Lighting
- ix. Rendering
- x. Problems and Solutions

3D Animation - Technical Render Job Exhibit Project Rating Sheet-State

Please place a copy of the rating sheet for each project entry at the front of the report folder.

The completed district notebook grading sheet with registration sticker and state qualifying stamp should be included in the notebook for state submission with the project. This rating sheet is for the project only at state which will be added to the district notebook grade.

The judges will judge each entry using the following criteria as a guide, along with their own knowledge of professional animation.

JUDGING CRITERIA		Maximum Points	Points Awarded
1	Modeling: Complexity, clean lines, realism	30	
2	Lighting: Is the lighting realistic? Are the lighting angles realistic? Does it convey the focus? Do shadows follow real world attributes? Is the lighting/shading distracting or emplacing?	30	
3	Composition Incorporates Elements and Principles of Design: The use of type, line, texture, pattern, form, contrast, color etc. enhances the entry?	30	
4	Impact: How well does the entry capture the attention of the viewer or target?	30	
5	Texturing: Complexity of textures, is the depth apparent and appropriate? Does the shading/specular match the subject?	30	
6	Interpretation and Complexity: Artistic ability, overall appeal with regard to technical renders of equal education and experience	30	
7	Production Quality and Presentation: Does the quality of the entry and workmanship enhance the final appearance of the work? This includes matting and overall neatness of the final project.	20	
8	Documentation (Notebook): Enter Score from Job Exhibit Notebook Rating Sheet	200	
Total Points		400	
PENALTIES			
1	Copyrighted Material: All content must be original OR royalty free	-20	
2	Dimensions: Entry must fit within a 2' x 2' x 3' space when displayed	-10	
Total Penalties		-30	
Note to Judges: If an exhibit is rated less than qualified for state or superior, the judges should explain why below:		TOTAL SCORE	

Score	STATE
360 - 400	Superior
320 – 359	Excellent
280 – 319	Very Good
0 - 279	N/A

State Registration Sticker Should Be Placed Here

Advertising Design Campaign Job Exhibit

Purpose

An advertising design campaign job exhibit is a series of advertisement messages that share a single idea and theme which advertise a company, product or event in any of the following categories.

Categories

- Logos
- Identity (Letterhead packages, brochures and catalogs)
- Packaging (No product or industrial design in this category)
- Posters
- Miscellaneous design (Invitations, announcements, wearables, etc.)
- Print Advertising
 - Consumer & Retail
 - Business to Business
 - Public Service
- Industrial Design (Appliances, clothing, automobiles etc.) – Mockup of advertisements

Specifications

- Entries must be started and completed during the current school year, beginning no earlier than August 1st.
- All content must be original
- Campaigns are projects created by an individual, group (2-5).
- Campaigns are a series of 3 or more pieces, counted as one entry.
- Elements of a Campaign cannot be entered in any other category.
- Pieces can all be from one category, such as 3 magazine ads or a series of varied pieces such as a billboard, radio script and television commercial, but all of the pieces should promote one product or service.
- Each exhibit must include a notebook secured in a binder or folder.

THIS DOCUMENT SHOULD BE THE 2nd ITEM IN YOUR NOTEBOOK AT DISTRICT

Elements & Principles of Design

Each entry should consider and apply basic elements and principles of design, including any of the following:

- Elements: line, shape, color, texture, pattern, value, form, type
- Principles: contrast, alignment, repetition, proximity, balance, unity, emphasis, rhythm, and proportion

Dimensions

Each submission or print may fill a space no larger than 3' x 3' x 3' when displayed, including matting and display stands.

All Job Exhibits Require a Notebook. Notebook description is found in this document titled Job Exhibit Notebook. The project notebook should demonstrate core academic abilities. The student should demonstrate the use of proper English, Math, and Science in the project. Academics should be a major emphasis in the notebook. Body of the notebook should include Conceptualization

- i. Modeling
- ii. Texturing
- iii. Lighting
- iv. Rendering

Advertising Design Campaign Job Exhibit Project Rating Sheet-State

Please place a copy of the rating sheet for each project entry at the front of the report folder.

The completed district notebook grading sheet with registration sticker and state qualifying stamp should be included in the notebook for state submission with the project. This rating sheet is for the project only at state which will be added to the district notebook grade.

The judges will judge each entry using the following criteria as a guide, along with their own knowledge of professional advertising.

JUDGING CRITERIA		Maximum Points	Points Awarded
1	Overall Design of Logo: Does it represent the product well? Is it easily distinguishable?	30	
2	Clarity of Message: Is the subject matter of the entry appropriate, timely, well planned, and have a clear purpose, and/or theme? Does it fulfill the need of the client? Is the message bold, compelling and possibly Multiple layered? Did it go beyond the obvious?	30	
3	Creativity and Originality: Does the entry present creative thought or an original idea? Does it show initiative and/or ingenuity?	30	
4	Impact: How well does the entry capture the attention of the viewer or target?	30	
5	Composition Incorporates Elements and Principles of Design: Does the use of type, line, texture, pattern, form, contrast, color etc. enhance the entry?	30	
6	Typography: Do the typefaces, fonts and effects help to create a strong verbal-visual connection within the work? Are font sizes appropriate?	30	
7	Production Quality and Presentation: Does the quality of the entry and workmanship enhance the final appearance of the work? This includes matting and overall neatness of the final project and notebook.	20	
8	Documentation (Notebook): Enter Score from Job Exhibit Notebook Rating Sheet	200	
Total Points		400	
PENALTIES			
1	Copyrighted Material: All content must be original OR royalty free	-20	
2	Dimensions: Entry must fit within a 3' x 3' x 3' space when displayed	-10	
Total Penalties		-30	
Note to Judges: If an exhibit is rated less than qualified for state or superior, the judges should explain why below:		TOTAL SCORE	
Judges Remarks:			

Score	STATE
360 - 400	Superior
320 – 359	Excellent
280 – 319	Very Good
0 - 279	N/A

**State Registration Sticker
Should Be Placed Here**

Advertising Design Job Exhibit

Purpose

An advertising design job exhibit is a single advertisement, which advertises a company, product or event in any of the following categories.

Categories

- Logos
- Identity (Letterhead packages, brochures and catalogs)
- Packaging (No product or industrial design in this category)
- Posters
- Miscellaneous design (Invitations, announcements, wearables, etc.)
- Print Advertising
 - Consumer & Retail
 - Business to Business
- Public Secure Announcement
- Point-of-Sale Mock-up

Specifications

- Entries must be started and completed during the current school year, beginning no earlier than August 1st.
- All content must be original
- Entry created by only one individual
- May submit only one entry from any of the categories listed
- Each exhibit must include a notebook secured in a binder or folder.

THIS DOCUMENT SHOULD BE THE 2nd ITEM IN YOUR NOTEBOOK AT DISTRICT

Elements & Principles of Design

Each entry should consider and apply basic elements and principles of design, including any of the following:

- Elements: line, shape, color, texture, pattern, value, form, type
- Principles: contrast, alignment, repetition, proximity, balance, unity, emphasis, rhythm, and proportion.

Dimensions

Each submission or print may fill a space no larger than 2' x 2' x 3' when displayed, including matting and display stands.

Notebook – see all job exhibit notebook specification sheet for more detail

- a. Cover Sheet
- b. Table of contents:
- c. Resume (If a group or Multiple project - each student must have resume.)
- d. Preface or Introduction
- e. Body of notebook
- f. Sketchup, or Vision Boarding
- g. Tool/Implementation/Equipment/Software List
- h. Student Work photos
- i. Bibliography – Sources of all material, including electronic, used in notebook.
- j. Complete Project photos

Advertising Design Job Exhibit Project Rating Sheet-State

Please place a copy of the rating sheet for each project entry at the front of the report folder.

The completed district notebook grading sheet with registration sticker and state qualifying stamp should be included in the notebook for state submission with the project. This rating sheet is for the project only at state which will be added to the district notebook grade.

The judges will judge each entry using the following criteria as a guide, along with their own knowledge of professional advertising.

JUDGING CRITERIA		Maximum Points	Points Awarded
1	Overall Design of Logo: Does it represent the product well? Is it easily distinguishable?	30	
2	Clarity of Message: Is the subject matter of the entry appropriate, timely, well planned, and have a clear purpose, and/or theme? Does it fulfill the need of the client? Is the message bold, compelling and possibly Multiple layered? Did it go beyond the obvious?	30	
3	Creativity and Originality: Does the entry present creative thought or an original idea? Does it show initiative and/or ingenuity?	30	
4	Impact: How well does the entry capture the attention of the viewer or target?	30	
5	Composition Incorporates Elements and Principles of Design: Does the use of type, line, texture, pattern, form, contrast, color etc. enhance the entry?	30	
6	Typography: Do the typefaces, fonts and effects help to create a strong verbal-visual connection within the work? Are font sizes appropriate?	30	
7	Production Quality and Presentation: Does the quality of the entry and workmanship enhance the final appearance of the work? This includes matting and overall neatness of the final project and notebook.	20	
8	Documentation (Notebook): Enter Score from Job Exhibit Notebook Rating Sheet	200	
Total Points		400	
PENALTIES			
1	Copyrighted Material: All content must be original OR royalty free	-20	
2	Dimensions: Entry must fit within a 2' x 2' x 3' space when displayed	-10	
Total Penalties		-30	
Note to Judges: If an exhibit is rated less than qualified for state or superior, the judges should explain below:		TOTAL SCORE	

Score	STATE
360 - 400	Superior
320 – 359	Excellent
280 – 319	Very Good
0 - 279	N/A

**State Registration Sticker
Should Be Placed Here**

Audio Production Job Exhibit

Purpose

An Audio Production job exhibit is a single recording, which indicates the student's ability to produce an audio production.

THIS DOCUMENT SHOULD BE THE 2nd ITEM IN YOUR NOTEBOOK AT DISTRICT

Specifications

- Entries must be started and completed during the current school year, beginning no earlier than August 1st.
- Entry created by one individual or multiple (2-5)

Notebook – see all job exhibit notebook specification sheet for more detail

- a. Cover Sheet
- b. Table of contents:
- c. Resume (If a group or Multiple project - each student must have resume.)
- d. Preface or Introduction
- e. Body of notebook
 - Preproduction: contact information, booking of the studio, email contact, etc.
 - Production Notes: Location Scouting, Talent Releases, etc.)
 - Detailed Description of Work: Timeline, Production Schedule, what problems did you encounter and how did you overcome them)
- f. Tool/Implementation/Equipment/Software List
- g. Material List (with receipts) or if donated list of items (acknowledge donator)
- h. Student Work photos
- i. Bibliography – Sources of all material, including electronic, used in notebook.
- j. Complete Project photos

Audio Production Job Exhibit Project Rating Sheet-State

Please place a copy of the rating sheet for each project entry at the front of the report folder.

The completed district notebook grading sheet with registration sticker and state qualifying stamp should be included in the notebook for state submission with the project. This rating sheet is for the project only at state which will be added to the district notebook grade.

The judges will rate each project in accordance with the following criteria, considering the points indicated:

PRODUCTION QUALITY	Points Allowed	Points Awarded
Levels: are balanced within industry standard and not clipping	0-40	
Audio Mixing: audio elements have proper relationship in mix	0-30	
Use of Music/Effects: the use of music/effects are appropriate for intent and mood of piece	0-30	
Lack of Distortion/Noise: product is free of extraneous sounds (pops, buzzes, and hisses)	0-40	
Talent: on mic performance and voice narration	0-20	
Originality: Does the project show originality and initiative and/or ingenuity?	0-40	
Documentation: Enter Score from Job Exhibit Notebook Rating Sheet	0-200	
Total Points	400	
PENALTIES		
Copyrighted Material: all content must be original <u>OR</u> royalty free <u>OR</u> proof of licensing	-50	
Time Penalty: must be 3 minutes or less.	-20	
Total Penalties	-70	
Note to Judges: If an exhibit is rated less than qualified for state or superior, the judges should explain below:	Total Score	

Score	STATE
360 - 400	Superior
320 – 359	Excellent
280 – 319	Very Good
0 - 279	N/A

**State Registration Sticker
Should Be Placed Here**

Automotive and Diesel Job Exhibits

- A.** Job exhibits must be single component, ready to install, typical of the occupation (mock-ups, teaching aids and carburetors not accepted.)
- B.** Machined, sealing or electrical conducting surfaces will not be painted.
- C.** Job specific score sheet included in the SkillsUSA Texas Regulations will be for judging and comments.
- D.** Batteries or fuel may not accompany job exhibits because of fire regulations.
- E.** Automotive and diesel components must be ready for installation on vehicles,
- F.** No Points will be given or taken away for the use of non-OEM parts.

Specific Rules

Notebook to be included with all exhibits:

The project notebook should demonstrate core academic abilities. The student should demonstrate the use of proper English, Math, and Science in the project. Academics should be a major emphasis in the notebook.

Notebook – see all job exhibit notebook specification sheet for more detail

- a. Cover Sheet
- b. Table of contents:
- c. Resume (If a group or Multiple project - each student must have resume.)
- d. Preface or Introduction
- e. Body of notebook
- f. Tool/Implementation/Equipment/Software List
- g. Material List (with receipts) or if donated list of items (acknowledge donator)
- h. Student Work photos
- i. Bibliography – Sources of all material, including electronic, used in notebook.
- j. Complete Project photos

Include in notebook in appropriate section

- Section G should include original parts invoice with current school year dates
- Section E ii should include step by step procedure in paragraph form of:
 - a. disassembly,
 - b. cleaning,
 - c. inspection,
 - d. testing,
 - e. adjustment,
 - f. assembly
- Section I Bibliography should include a printed copy of the referenced procedures that were used to complete the task. Photocopies of printed materials and diagrams (Mitchell on Demand, All Data, or OE repair information) may be used.

NOTE: MULTIPLE (2-5) AND CHAPTER (6 OR MORE) PROJECTS: EACH CONTESTANTS MUST MEET TECHNICAL STANDARDS PER EXHIBIT WHEN MULTIPLE COMPONENTS OR PROJECTS ARE ASSUMED OR DISPLAYED TOGETHER.

Automotive and Diesel Job Exhibits-Page 2

If indicated here, please be sure a picture includes item noted.

I. Cylinder Head Projects

1. **Must be** displayed with all valves of one combustion chamber removed and all valves must accompany the project. **(No keepers, springs, seals, or retainers should be included with the displayed valves.)**
2. Displayed valves must show face to seat contact patch and be within specifications.
3. No polished valve ports or combustion chambers.
4. All rust, carbon, grease, old gasket, and dirt must be removed.
5. Stem to guide clearance must meet manufacturer's specifications as stated in the project notebook.
6. Head deck surface must meet manufacturer's specifications

II. Engines Long Block (No complete Engines.)

1. Must be displayed on an engine stand, with the oil pan, timing cover(s) and valve cover(s) removed for inspection.
2. Accessories must not be installed (i.e. manifolds, starter, alternator, brackets, distributors, pulleys, water pump, fuel pump, spark plugs, or engine mounts).
3. Oil pumps must be installed.
4. All valve train components must be installed and adjusted.

III. Engine Short Blocks

1. Assemblies **must be** displayed on engine stands (**no** lifters, oil pan, timing cover, or oil pump).
2. Short blocks **must** include; block, pistons with rings installed, camshaft, crankshaft, timing gears, chain and gears (**except** overhead cam blocks).

IV. Automatic Transmissions/ Trans Axle

1. **Must be** displayed with the **pan off** and **NO** torque converter, pan or gasket are to be displayed.
2. Shift lever and modulator **must be** installed if required.
3. Paint is optional.

V. Manual Transmissions/ Trans Axles

1. **Must be** displayed with shift cover or inspection plate removed and NOT displayed with project. Paint optional.

VI. Rear Wheel Drive Differential

1. Ring gear **must be** visible and marked for tooth contact pattern.

VII. Electrical Components

1. Alternator and generator electrically conductive surfaces **must not** be painted.
2. **All** starters and alternators **will be** subjected to random testing at the state level.

VIII. Diesel Components

1. **Will be** limited to diesel cylinder heads and or engine accessories components. (starters, alternators, blowers and turbochargers)

IX. Brake Components

1. Master cylinders **will not** be painted or brake fluid in the reservoir.
2. Master cylinders **will not** be mounted on a brake booster or stand.
3. Drums, Rotors, and wheel cylinders are **not considered Projects.**

X. Miscellaneous

1. Miscellaneous projects **not** mentioned above will be judged under the **General Rules**, and the job-rating sheet. Carburetors are no longer considered a viable project.

THIS DOCUMENT SHOULD BE THE 2nd ITEM IN YOUR NOTEBOOK AT DISTRICT

Automotive – Diesel Job Exhibit Project Rating Sheet-State

Please place a copy of the rating sheet for each project entry at the front of the report folder.

The completed district notebook grading sheet with registration sticker and state qualifying stamp should be included in the notebook for state submission with the project. This rating sheet is for the project only at state which will be added to the district notebook grade.

Judging Criteria	Points Allowed	Points Awarded
1. Does the project meet the job specific rules of the automotive student job exhibit contest?	100	
Comment		
2. Does the project meet the standards of the occupation for quality, finish, neatness, and pleasing in appearance?	50	
Comment		
3. Does the project show that considerable study and effort was expended in the disassembly, construction or assembly of the project?	50	
Comment		
4. Notebook Enter Score from Job Exhibit Notebook Rating Sheet	200	
Note to Judges: If an exhibit is rated less than qualified for state or superior, the judges should explain below:	Total Points	

Remarks:

Score	STATE
360 - 400	Superior
320 – 359	Excellent
280 – 319	Very Good
0 - 279	N/A

**State Registration Sticker
Should Be Placed Here**

Automotive – Motorcycle Technology Job Exhibit Project Rating Sheet-State

Please place a copy of the rating sheet for each project entry at the front of the report folder.

The completed district notebook grading sheet with registration sticker and state qualifying stamp should be included in the notebook for state submission with the project. This rating sheet is for the project only at state which will be added to the district notebook grade.

Judging Criteria	Points Allowed	Points Awarded
1. Job exhibit must be single engine (single or Multiple-cylinder), ready to install on end item?	20 Points	
2. Is the job exhibit typical of the occupation, and does the job show originality and initiative on the part of the contestant?	40 Points	
3. Does the engine accurately meet the specifications or description submitted with the job, and does it have adequate evidence of the work performed.	40 Points	
4. Engine must not be a new engine, disassembled and reassembled.	20 Points	
5. Does the engine meet the standards of the occupation for quality, finish, and is it restored to original manufacture specifications?	40 Points	
6. Does the engine indicate considerable study and effort was expended in its disassembly, repair and reassembly?	40 Points	
7. Notebook: Enter Score from Job Exhibit Notebook Rating Sheet	200	
Note to Judges: If an exhibit is rated less than qualified for state or superior, the judges should explain below:		
TOTAL SCORE 400 points possible		
Remarks:		

Score	STATE
360 - 400	Superior
320 – 359	Excellent
280 – 319	Very Good
0 - 279	N/A

**State Registration Sticker
Should Be Placed Here**

Automotive - Outdoor Power Equipment Job Exhibit Project Rating Sheet-State

Please place a copy of the rating sheet for each project entry at the front of the report folder.

The completed district notebook grading sheet with registration sticker and state qualifying stamp should be included in the notebook for state submission with the project. This rating sheet is for the project only at state which will be added to the district notebook grade.

Judging Criteria	Points Allowed	Points Awarded
1. Job exhibit must be single engine (single or Multiple-cylinder), ready to install on end item?	20 Points	
2. Is the job exhibit typical of the occupation, and does the job show originality and initiative on the part of the contestant?	40 Points	
3. Does the engine accurately meet the specifications or description submitted with the job, and does it have adequate evidence of the work performed.	40 Points	
4. Engine must not be a new engine, disassembled and reassembled.	20 Points	
5. Does the engine meet the standards of the occupation for quality, finish and is it restored to original manufacture specifications?	40 Points	
6. Does the engine indicate considerable study and effort was expended in its disassembly, repair and reassembly?	40 Points	
7. Notebook: Enter Score from Job Exhibit Notebook Rating Sheet	200	
Note to Judges: If an exhibit is rated less than qualified for state or superior, the judges should explain below:		
TOTAL SCORE 400 points possible		

Judges Remarks:

Score	STATE
360 - 400	Superior
320 – 359	Excellent
280 – 319	Very Good
0 - 279	N/A

**State Registration Sticker
Should Be Placed Here**

Automotive Single Engine Ready to Install Project Rating Sheet-State

Please place a copy of the rating sheet for each project entry at the front of the report folder.

(Single or Multiple-Cylinder Engine)

The completed district notebook grading sheet with registration sticker and state qualifying stamp should be included in the notebook for state submission with the project. This rating sheet is for the project only at state which will be added to the district notebook grade.

Judging Criteria	Points Allowed	Points Awarded
1. Job exhibit is typical of occupation and is original and shows initiative on the part of the contestant	40	
2. Engine accurately meets the specifications or description specified in the student notebook and shows adequate evidence of the work performed. Engine cannot be new, must be disassembled and rebuilt	40	
3. Engine meets the standards of the occupation for quality, finish, and the engine restored to original manufacturer's specifications	60	
4. The engine must indicate that considerable study and effort was expended in its disassembly, repair, and reassembly	60	
5. Notebook: Enter Score from Job Exhibit Notebook Rating Sheet	200	
Note to Judges: If an exhibit is rated less than qualified for state or superior, the judges should explain below:		
TOTAL SCORE 400 points possible		

Judges Remarks:

Score	STATE
360 - 400	Superior
320 - 359	Excellent
280 - 319	Very Good
0 - 279	N/A



Automotive Collision Repair Job Exhibits Project Rating Sheet-State

Please place a copy of the rating sheet for each project entry at the front of the report folder.

Purpose

A collision repair job exhibit should represent a typical repair job in the collision repair field.

Notebook description is found in this document titled Job Exhibit Notebook.

The project notebook should demonstrate core academic abilities. The student should demonstrate the use of proper English, Math, and Science in the project. Academics and documentation should be a major emphasis in the notebook.

The completed district notebook grading sheet with registration sticker and state qualifying stamp should be included in the notebook for state submission with the project. This rating sheet is for the project only at state which will be added to the district notebook grade.

Judging Criteria	Points Allowed	Points Awarded
1. Is the job typical of the occupation, and does the job show originality and initiative and/or ingenuity on the part of the contestant?	20	
2. Does the job accurately meet the specifications or description submitted with the job, and does it have adequate evidence of the work performed.	20	
3. Does the job meet the standards of the occupation for quality, finish, neatness, pleasing in appearance?	40	
A. Quality	20	
B. Finish	10	
C. Neatness	20	
D. Pleasing in appearance	20	
4. Does the job indicate that considerable study and effort was expended? In its design (if applicable), construction, assembly and/or arrangement.	50	
5. Notebook: Enter Score from Job Exhibit Notebook Rating Sheet	200	
Note to Judges: If an exhibit is rated less than qualified for state or superior, the judges should explain below:		
TOTAL SCORE 400 points possible		

Judges Remarks:

Score	STATE
360 - 400	Superior
320 – 359	Excellent
280 – 319	Very Good
0 - 279	N/A

**State Registration Sticker
Should Be Placed Here**

Automotive Collision Repair Custom Repair Project Rating Sheet-State

Please place a copy of the rating sheet for each project entry at the front of the report folder.

Purpose

A custom collision repair job exhibit is a custom repair job that displays an artistic flare to the repair job. To allow student the ability express creativity in their design.

Notebook description is found in this document titled Job Exhibit Notebook.

The project notebook should demonstrate core academic abilities. The student should demonstrate the use of proper English, Math, and Science in the project. Academics and documentation should be a major emphasis in the notebook

The completed district notebook grading sheet with registration sticker and state qualifying stamp should be included in the notebook for state submission with the project. This rating sheet is for the project only at state which will be added to the district notebook grade.

Judging Criteria	Points Allowed	Points Awarded
1. Is the job typical of the occupation, and does the job show originality and initiative and/or ingenuity on the part of the contestant?	10	
2. Does the job accurately meet the specifications or description submitted with the job, and does it have adequate evidence of the work performed.	10	
3. Does the job meet the standards of the occupation for quality, finish, neatness, pleasing in appearance?	20	
A. Quality	30	
B. Finish	30	
C. Neatness	30	
D. Pleasing in appearance	30	
4. Does the job indicate that considerable study and effort was expended? In its design (if applicable),	40	
5. Notebook: Enter Score from Job Exhibit Notebook Rating Sheet	200	
Note to Judges: If an exhibit is rated less than qualified for state or superior, the judges should explain below: TOTAL SCORE 400 points possible		

Judges Remarks:

Score	STATE
360 - 400	Superior
320 – 359	Excellent
280 – 319	Very Good
0 - 279	N/A

**State Registration Sticker
Should Be Placed Here**

Cabinetmaking/Millwork Job Exhibit

Purpose

A job exhibit that demonstrates carpentry skills in one of the following areas.

- Indoor decorative
- Indoor furniture
- Outdoor decorative

Projects such as picnic tables or construction wall frames should be entered as carpentry job exhibits.

THIS DOCUMENT SHOULD BE THE 2nd ITEM IN YOUR NOTEBOOK AT DISTRICT

Notebook – see all job exhibit notebook specification sheet for more detail

- a. Cover Sheet
- b. Table of contents:
- c. Resume (If a group or Multiple project - each student must have resume.)
- d. Preface or Introduction
- e. Body of notebook
- f. Tool/Implementation/Equipment/Software List
- g. Material List (with receipts) or if donated list of items (acknowledge donator)
- h. Student Work photos
- i. Bibliography – Sources of all material, including electronic, used in notebook.
- j. Complete Project photos

Notebook to be included with all exhibits:

The project notebook should demonstrate core academic abilities. The student should demonstrate the use of proper English, Math, and Science in the project. Academics should be a major emphasis in the notebook.

Cabinetmaking/Millwork Job Exhibit Project Rating Sheet-State

Please place a copy of the rating sheet for each project entry at the front of the report folder.

Circle a category: Indoor decorative Indoor Furniture Outdoor decorative Outdoor Furniture

The completed district notebook grading sheet with registration sticker and state qualifying stamp should be included in the notebook for state submission with the project. This rating sheet is for the project only at state which will be added to the district notebook grade.

Judging Criteria	Points Allowed	Points Awarded
6. Is the job typical of the occupation, and does the job show originality and initiative and/or ingenuity on the part of the contestant?	20	
7. Does the job accurately meet the specifications or description submitted with the job, and does it have adequate evidence of the work performed.	20	
3. Does the job meet the standards of the occupation for quality, finish, neatness, pleasing in appearance?	40	
A. Precision (overall dimensional accuracy)	20	
B. Quality (correct/appropriate joinery and tightness/flushness of joints and assembly)	20	
C. Finish (type appropriate to the piece and execution of the finish system (sheen, fill, defects such orange peel, drips, sags, etc.)	20	
D. Overall Aesthetic (material selection, matching of solid to veneer, color, etc.)	20	
4. Does the job indicate that considerable study and effort was expended? In its design (if applicable), construction, assembly and/or arrangement.	40	
5. Notebook: Enter Score from Job Exhibit Notebook Rating Sheet	200	
Note to Judges: If an exhibit is rated less than qualified for state or superior, the judges should explain below:		
TOTAL SCORE 400 points possible		

Judges Remarks:

Score	STATE
360 - 400	Superior
320 – 359	Excellent
280 – 319	Very Good
0 - 279	N/A

**State Registration Sticker
Should Be Placed Here**

Carpentry Job Exhibit

Purpose

A job exhibit that demonstrates carpentry skills in one of the following areas.

- Outdoor recreation
- Construction grade
- Indoor utility

Projects such as dressers, cabinets, decorative tables should be entered under cabinetmaking/millwork.

THIS DOCUMENT SHOULD BE THE 2nd ITEM IN YOUR NOTEBOOK AT DISTRICT

Notebook – see all job exhibit notebook specification sheet for more detail

- a. Cover Sheet
- b. Table of contents:
- c. Resume (If a group or Multiple project - each student must have resume.)
- d. Preface or Introduction
- e. Body of notebook
- f. Tool/Implementation/Equipment/Software List
- g. Material List (with receipts) or if donated list of items (acknowledge donator)
- h. Student Work photos
- i. Bibliography – Sources of all material, including electronic, used in notebook.
- j. Complete Project photos

Notebook to be included with all exhibits:

The project notebook should demonstrate core academic abilities. The student should demonstrate the use of proper English, Math, and Science in the project. Academics should be a major emphasis in the notebook.

Carpentry Job Exhibit Project Rating Sheet-State

Please place a copy of the rating sheet for each project entry at the front of the report folder.

Circle a category: Outdoor recreation Construction Grade Indoor utility

The completed district notebook grading sheet with registration sticker and state qualifying stamp should be included in the notebook for state submission with the project. This rating sheet is for the project only at state which will be added to the district notebook grade.

Judging Criteria	Points Allowed	Points Awarded
1. Is the job typical of the occupation, and does the job show originality and initiative and/or ingenuity on the part of the contestant?	20	
2. Does the job accurately meet the specifications or description submitted with the job, and does it have adequate evidence of the work performed.	20	
3. Does the job meet the standards of the occupation for quality, finish, neatness, pleasing in appearance?	40	
A. Precision (overall dimensional accuracy)	20	
B. Quality (correct/appropriate joinery and tightness/flushness of joints and assembly)	20	
C. Finish (type appropriate to the piece and execution of the finish system (sheen, fill, defects such orange peel, drips, sags, etc.))	20	
D. Overall Aesthetic (material selection, matching of solid to veneer, color, etc.)	20	
4. Does the job indicate that considerable study and effort was expended? In its design (if applicable), construction, assembly and/or arrangement.	40	
5. Notebook: Enter Score from Job Exhibit Notebook Rating Sheet	200	
Note to Judges: If an exhibit is rated less than qualified for state or superior, the judges should explain below:		
TOTAL SCORE 400 points possible		

Judges Remarks:

Score	STATE
360 - 400	Superior
320 – 359	Excellent
280 – 319	Very Good
0 - 279	N/A

**State Registration Sticker
Should Be Placed Here**

Commercial Baking – Baked Goods Job Exhibit

This is an individual only job exhibit. Texas Only Contest

ELIGIBILITY

Student must be currently enrolled in Hospitality and Tourism Pathway course. Projects are to be student designed, arranged, and completed during the current school year in which the exhibit is to be submitted for judging.

PURPOSE

To allow student the ability express creativity with baked goods and to enter a display describing the skills learned during project creation. i.e. Breads, pies, cookies, cupcakes.

THIS DOCUMENT SHOULD BE THE 2nd ITEM IN YOUR NOTEBOOK AT DISTRICT

RULES

1. The baked goods project will consist of a minimum of 10 photographs of the student-performed tasks, photos should be taken of every task completed for the project.
2. **Must utilize the theme for competition year provided by the state office.**
3. Notebook description is found in this document titled Job Exhibit Notebook. The project notebook should demonstrate core academic abilities. The student should demonstrate the use of proper English, Math, and Science in the project. Academics should be a major emphasis in the notebook
4. The project shall be displayed in an area that is no larger than 2' x 2' area on table. If project exceeds given dimensions it will not be displayed.
5. Each student will be permitted one entry in the project exhibit.
6. Projects are to be student designed, arranged, and completed during the current school year in which the exhibit is to be displayed.
7. Job Exhibit notebook score sheets with registration stickers attached and district qualifying stamp along with project score sheet below with state registration sticker attached must be in the notebook.
8. The project will be judged as indicated on the rating sheet.

NOTE TO ADVISORS

- Pictures must show face and hands together of actual students creating the project.
- Creations must be edible
- Any content deemed inappropriate for a secondary school project, will be disqualified.
- Any projects that are not edible will not be judged.

Notebook description is found in this document titled Job Exhibit Notebook.

The project notebook should demonstrate core academic abilities. The student should demonstrate the use of proper English, Math, and Science in the project. Academics should be a major emphasis in the notebook

COMMERCIAL BAKING – Baked Goods Job Exhibit Project Rating Sheet-State

The completed district notebook grading sheet with registration sticker and state qualifying stamp should be included in the notebook for state submission with the project. This rating sheet is for the project only at state which will be added to the district notebook grade. A state registration sticker must be attached to this sheet to be graded at state.

1. Does the project reflect a clever adaptation of an original / creative idea through the use of multiple techniques?				Score
At least 3 unique techniques and project fully demonstrates originality and intuition.	At least 3, unique techniques and project shows some originality and intuition.	Only 2 unique technique and project shows little originality and intuition.	1 unique technique and project does not show originality and intuition.	
Points: 80	Points: 60	Points: 40	Points: 20	
2. Does the project meet the professional standards and appeal for baking industry: finish, neatness, pleasing in appearance?				Score
Superior Quality, Finish, and Appearance	Excellent Quality, Finish, and Appearance	Good Quality, Finish, and Appearance	OK Quality, Finish, and Appearance	
Points: 60	Points: 50	Points: 40	Points: 20	
3. Does the project indicate that considerable study and effort was spent on total design components such as: construction, assembly and/or arrangement?				Score
Spent obvious time and effort to complete project Looks impressive	Spent time and effort to complete project Looks appealing	Spent some time and effort to complete project Somewhat appealing	Spent little time and effort to complete project Does not look appealing	
Points: 60	Points: 50	Points: 40	Points: 20	
If any part of the notebook is not available, student may lose 200 points for an incomplete notebook. Enter Score from Notebook Rating Sheet max 200 points			District Notebook Score	
Total Score, 400 points maximum				

Judges Remarks

Score	STATE
360 - 400	Superior
320 – 359	Excellent
280 – 319	Very Good
0 - 279	N/A

**State Registration Sticker
Should Be Placed Here**

Commercial Baking – Showpiece Job Exhibit

Students can enter only 1 job exhibit. This can be individual or group job exhibit. Texas Only Contest.

ELIGIBILITY

Student must be currently enrolled in Hospitality and Tourism Pathway course.

PURPOSE

To allow student the ability express creativity through food design and to enter a display describing the skills learned during project creation. i.e. Bread, sugar, and chocolate sculptures, cookie house, sculpted 6+ tier cakes or multiple dimension products.

THIS DOCUMENT SHOULD BE THE 2nd ITEM IN YOUR NOTEBOOK AT DISTRICT

RULES

1. The baked goods project will consist of a minimum of 10 photographs of the student-performed tasks, photos should be taken of every task completed for the project.
2. **Must utilize the theme for competition year provided by the state office.**
3. **Notebook description is found in this document titled Job Exhibit Notebook.** The project notebook should demonstrate core academic abilities. The student should demonstrate the use of proper English, Math, and Science in the project. Academics should be a major emphasis in the notebook
4. The project shall be displayed in an area that is no larger than 2' x 2' area on table. If project exceeds given dimensions it will not be displayed.
5. Each student will be permitted one entry in the project exhibit.
6. Projects are to be student designed, arranged, and completed during the current school year in which the exhibit is to be displayed.
7. Job Exhibit notebook score sheets with registration stickers attached and district qualifying stamp along with project score sheet below with state registration sticker attached must be in the notebook.
8. The project will be judged as indicated on the rating sheet.

NOTE TO ADVISORS

- Pictures must show face and hands, together, of actual students creating the project.
- Decorations must be edible, it is recommended cake bases not be edible
- Any content deemed inappropriate for a secondary school project, will be disqualified.
- Any projects that are not edible will not be judged.

Commercial Baking Job Exhibit – Showpiece Project Rating Sheet-State

DECORATIONS MUST BE EDIBLE IN NATURE AND NOT USE TRADEMARKED /COPYWRITE MATERIALS OR IDEAS
Please place a copy of the rating sheet for each project entry at the front of the report folder.

The completed district notebook grading sheet with registration sticker and state qualifying stamp should be included in the notebook for state submission with the project. This rating sheet is for the project only at state which will be added to the district notebook grade.

1. Does the project reflect a clever adaptation of an original / creative idea through the use of multiple techniques?				Score
At least 5 unique techniques and project fully shows originality and intuition.	At least 4 unique techniques and project shows some originality and intuition.	Only 3 unique techniques and project shows little originality and intuition.	2 or fewer unique techniques and project does not show originality and intuition.	
Points: 80	Points: 60	Points: 40	Points: 20	
2. Does the project meet the professional standards and appeal for baking industry: finish, neatness, pleasing in appearance?				Score
Superior Quality, Finish, and Appearance	Excellent Quality, Finish, and Appearance	Good Quality, Finish, and Appearance	OK Quality, Finish, and Appearance	
Points: 60	Points: 50	Points: 40	Points: 20	
3. Does the project indicate that considerable study and effort was spent on total design components such as: construction, assembly and/or arrangement?				Score
Spent obvious time and effort to complete project Looks impressive	Spent time and effort to complete project Looks appealing	Spent some time and effort to complete project Somewhat appealing	Spent little time and effort to complete project Does not look appealing	
Points: 60	Points: 50	Points: 40	Points: 20	
If any part of the notebook is not available, student may lose 200 points for an incomplete notebook. Enter Score from Notebook Rating Sheet max 200 points			District Notebook Score	
Total Score, 400 points maximum				

*If an exhibit is rated less than qualified for state or superior, then the judges should explain why below:

Judges Remarks	

Score	STATE
360 - 400	Superior
320 – 359	Excellent
280 – 319	Very Good
0 - 279	N/A

**State Registration Sticker
Should Be Placed Here**

Commercial Baking – 1-2 Tier Cakes Job Exhibit

Students can enter only 1 job exhibit. This project guide is for individuals only Texas Only Contest

ELIGIBILITY

Student must be currently enrolled in Hospitality and Tourism Pathway course.

PURPOSE

To allow student the ability express creativity through edible cake design and to enter a display describing the skills learned during project creation.

THIS DOCUMENT SHOULD BE THE 2nd ITEM IN YOUR NOTEBOOK AT DISTRICT

RULES

1. The cake project will consist of a minimum of 10 photographs of the student-performed tasks, photos should be taken of every task completed for the project.
2. **Must utilize the theme for competition year provided by the state office.**
3. **Notebook description is found in this document titled Job Exhibit Notebook.** The project notebook should demonstrate core academic abilities. The student should demonstrate the use of proper English, Math, and Science in the project. Academics should be a major emphasis in the notebook.
4. The cake project shall be displayed in an area that is no larger than 2' x 2' area on table. If cake exceeds given dimensions it will not be displayed.
5. Each student will be permitted one entry in the cake project exhibit.
6. Cake projects are to be student designed, arranged, and completed during the current school year in which the exhibit is to be displayed.
7. Job Exhibit notebook score sheets with registration stickers attached and district qualifying stamp along with project score sheet below with state registration sticker attached must be in the notebook.
8. The cake project will be judged as indicated on the rating sheet.

NOTE TO ADVISORS

- Pictures must show face and hands, together, of actual students creating the project.
- Decorations must be edible, it is recommended cake bases not be edible
- Any content deemed inappropriate for a secondary school project, will be disqualified.
- Any projects that are not edible will not be judged.

Commercial Baking Job Exhibit – 1-2 Tier Project Rating Sheet-State

DECORATIONS MUST BE EDIBLE IN NATURE AND NOT USE TRADEMARKED /COPYWRITE MATERIALS OR IDEAS
Please place a copy of the rating sheet for each project entry at the front of the report folder.

The completed district notebook grading sheet with registration sticker and state qualifying stamp should be included in the notebook for state submission with the project. This rating sheet is for the project only at state which will be added to the district notebook grade.

Does the project reflect a clever adaptation of an original / creative idea through the use of multiple techniques?				Score
At least 4 unique techniques and project fully shows originality and intuition.	At least 3 unique techniques and project shows some originality and intuition.	Only 2 unique techniques and project shows little originality and intuition.	1 unique technique and project does not show originality and intuition.	
Points: 80	Points: 60	Points: 40	Points: 20	
Does the project meet the professional standards and appeal for baking industry: finish, neatness, pleasing in appearance?				Score
Superior Quality, Finish, and Appearance	Excellent Quality, Finish, and Appearance	Good Quality, Finish, and Appearance	OK Quality, Finish, and Appearance	
Points: 60	Points: 50	Points: 40	Points: 20	
Does the project indicate that considerable study and effort was spent on total design components such as: construction, assembly and/or arrangement?				Score
Spent obvious time and effort to complete project Looks impressive	Spent time and effort to complete project Looks appealing	Spent some time and effort to complete project Somewhat appealing	Spent little time and effort to complete project Does not look appealing	
Points: 60	Points: 50	Points: 40	Points: 20	
If any part of the notebook is not available, student may lose 200 points for an incomplete notebook. Enter Score from Notebook Rating Sheet max 200 points			District Notebook Score max 200	
Total Score, 400 points maximum				

*If an exhibit is rated less than qualified for state or superior, then the judges should explain why below:

Judges Remarks

Score	STATE
360 - 400	Superior
320 – 359	Excellent
280 – 319	Very Good
0 - 279	N/A

**State Registration Sticker
Should Be Placed Here**

Commercial Baking – 3-5 Tier Cakes Job Exhibit

Students can enter only 1 job exhibit. This project guide is for individual or group.

ELIGIBILITY

Student must be currently enrolled in Hospitality and Tourism Pathway course.

PURPOSE

To allow student the ability express creativity through edible cake design and to enter a display describing the skills learned during project creation.

THIS DOCUMENT SHOULD BE THE 2nd ITEM IN YOUR NOTEBOOK AT DISTRICT

RULES

1. The cake project will consist of a minimum of 10 photographs of the student-performed tasks, photos should be taken of every task completed for the project.
2. **Must utilize the theme for competition year provided by the state office.**
3. **Notebook description is found in this document titled Job Exhibit Notebook.** The project notebook should demonstrate core academic abilities. The student should demonstrate the use of proper English, Math, and Science in the project. Academics should be a major emphasis in the notebook.
4. The cake project shall be displayed in an area that is no larger than 2' x 2' area on table. If cake exceeds given dimensions it will not be displayed.
5. Each student will be permitted one entry in the cake project exhibit.
6. Cake projects are to be student designed, arranged, and completed during the current school year in which the exhibit is to be displayed.
7. Job Exhibit notebook score sheets with registration stickers attached and district qualifying stamp along with project score sheet below with state registration sticker attached must be in the notebook.
8. The cake project will be judged as indicated on the rating sheet.

NOTE TO ADVISORS

- Pictures must show face and hands, together, of actual students creating the project.
- Decorations must be edible, it is recommended cake bases not be edible
- Any content deemed inappropriate for a secondary school project, will be disqualified.
- Any projects that are not edible will not be judged.

Commercial Baking Job Exhibit – 3-5 Tier Project Rating Sheet-State

DECORATIONS MUST BE EDIBLE IN NATURE AND NOT USE TRADEMARKED /COPYWRITE MATERIALS OR IDEAS

Please place a copy of the rating sheet for each project entry at the front of the report folder.

The completed district notebook grading sheet with registration sticker and state qualifying stamp should be included in the notebook for state submission with the project. This rating sheet is for the project only at state which will be added to the district notebook grade.

Does the project reflect a clever adaptation of an original / creative idea through the use of multiple techniques?				Score
At least 4 unique techniques and project fully shows originality and intuition.	At least 3 unique techniques and project shows some originality and intuition.	Only 2 unique techniques and project shows little originality and intuition.	1 unique technique and project does not show originality and intuition.	
Points: 80	Points: 60	Points: 40	Points: 20	
Does the project meet the professional standards and appeal for baking industry: finish, neatness, pleasing in appearance?				Score
Superior Quality, Finish, and Appearance	Excellent Quality, Finish, and Appearance	Good Quality, Finish, and Appearance	OK Quality, Finish, and Appearance	
Points: 60	Points: 50	Points: 40	Points: 20	
Does the project indicate that considerable study and effort was spent on total design components such as: construction, assembly and/or arrangement?				Score
Spent obvious time and effort to complete project Looks impressive	Spent time and effort to complete project Looks appealing	Spent some time and effort to complete project Somewhat appealing	Spent little time and effort to complete project Does not look appealing	
Points: 60	Points: 50	Points: 40	Points: 20	
If any part of the notebook is not available, student may lose 200 points for an incomplete notebook. Enter Score from Notebook Rating Sheet max 200 points			District Notebook Score max 200	
Total Score, 400 points maximum				

*If an exhibit is rated less than qualified for state or superior, then the judges should explain why below:

Remarks:

Score	STATE
360 - 400	Superior
320 – 359	Excellent
280 – 319	Very Good
0 - 279	N/A



Computer Maintenance Job Exhibit

Students can only enter 1 job exhibit. This project guide is for individual or group (2-5)

Categories

- Business
 - This should be a pre-planned computer production that is made from store bought components and parts.
 - The computer needs to have a specific work function, task, and/or audience in mind (CAD modeling, Server, Small business computer, cheap computer for Grandma)
 - Estimates, budgets, and pricing do matter.
 - \$2000 max on budget and required material lists (with receipts)

- Fantasy
 - This should be an innovative, reimagined computer production that is made from bought or donated components.
 - The computer needs to have a specific thematic construction and not be a typical computer case.
 - Designs, schematics, and craftsmanship do matter.
 - Suggested \$2000 max on budget and required material lists (with receipts)

THIS DOCUMENT SHOULD BE THE 2nd ITEM IN YOUR NOTEBOOK AT DISTRICT

Judging

There should be a minimum of two judges for each computer, with the scores averaged. Best of Show may be awarded for each category (business/fantasy) and overall Best of Show in IT.

All Job Exhibits Require a Notebook. Notebook description is found in this document titled Job Exhibit Notebook. The project notebook should demonstrate core academic abilities. The student should demonstrate the use of proper English, Math, and Science in the project. Academics should be a major emphasis in the notebook.

Computer Maintenance Job Exhibit Project Rating Sheet-State

Please place a copy of the rating sheet for each project entry at the front of the report folder.

*Please Select One: **Business** [] or **Fantasy** []*

The completed district notebook grading sheet with registration sticker and state qualifying stamp should be included in the notebook for state submission with the project. This rating sheet is for the project only at state which will be added to the district notebook grade.

Criteria 1 – Job Occupation (50 Points Max)	Points Awarded	Criteria Total
1. Does the completed job fit the intended purpose of the project proposal? (0-13 points)		
2. Does the project fit the thematic element described? (0-12 points)		
3. Is the job functional and marketable for its intended audience? (0-13 points)		
4. Is the design innovative and deviates from normal computer builds? (0-12 points)		
<i>***Judges, please write in Zeros when no points were earned.</i>	C-1 Total (50):	
Criteria 2 – Craftsmanship (50 Points Max)		
1. What is the level of neatness and the quality of the work? (0-20 points)		
2. Is the completed project aesthetically pleasing? (0-15 points)		
3. Is there evidence of effort throughout the project's design? (0-15 points)		
	C-2 Total (50):	
Criteria 3 – Complexity (50 Points Max)		
1. How would you rate the level of difficulty or complexity in the original design or proposal? (0-25 points)		
2. Does the level of work in the project reflect the level of difficulty of the overall intended project? (0-25 points)		
	C-3 Total (50):	
Criteria 4 – Operating System (50 Points Max)		
1. Does the operating system meet the needs of its intended audience? (0-25 points)		
2. Is the software and applications installed relevant for the project? (0-25 points)		
	C-4 Total (50):	
Criteria 5 – Notebook	Enter Score from Job Exhibit Notebook Rating Sheet max 200 points	C-5 Total (200):
Overall Project Total possible 400 points		
<i>**If an exhibit is rated less than qualified for state or superior, then the judges should explain why below:</i>		
Remarks		

Score	STATE
360 - 400	Superior
320 – 359	Excellent
280 – 319	Very Good
0 - 279	N/A

State Registration Sticker Should Be Placed Here

Cosmetology Job Exhibits

Students can enter only 1 job exhibit. This project guide is for individual or group.

Purpose: To evaluate contestant's mastery of entry level job skills and to recognize outstanding students for excellence and professionalism in the specific cosmetology exhibit category.

All Job Exhibits Require a Notebook. Notebook description is found in this document titled Job Exhibit Notebook. The project notebook should demonstrate core academic abilities. The student should demonstrate the use of proper **English, Math, and Science** in the project. Academics should be a major emphasis in the notebook.

Only the notebook is judged at district. Place the registration sticker on the notebook grading sheet as indicated. Notebook will not be graded without registration sticker.

The notebook should go with the project if it advances to state. The state registration sticker must be on the project grading sheet to be judged at state.

Judges choice for Best of Show – see Best of Show in this document for more information.

Oversized projects will be disqualified.

Do not put score sheets inside a sheet protector.

The project base is not gradeable.

THIS DOCUMENT SHOULD BE THE 2nd ITEM IN YOUR NOTEBOOK AT DISTRICT

Rating Sheets for each specific category follow below:

- **Braiding**
- **Day Evening**
- **Fantasy**
- **Men's Classic Cut**
- **Men's Design Cut**
- **Flat Nail Art**
- **Nail Art 3D**
- **Salon Job Exhibit**
- **Women's Edge Cut & Color**

Cosmetology – Braiding/Hair Extensions Job Exhibit Project Rating Sheet-State

Please place a blank copy of the rating sheet for each project entry at the front of the report folder. Individual Contest Only

Maximum Dimension: Base 24" x 24" Height 24"

The completed district notebook grading sheet with registration sticker and state qualifying stamp should be included in the notebook for state submission with the project. This rating sheet is for the project only at state which will be added to the district notebook grade.



Purpose: To evaluate contestant's mastery of entry-level job skills and to recognize outstanding students for excellence and professionalism in the field of Braiding and Hair Extensions

Student level: (circle one) 9th 10th 11th 12th

Braiding & Hair Extensions	MAX POINTS	
Notebook: Enter Score from Job Exhibit Notebook Rating	200	
Design & Originality	60	
Smoothness	40	
Clean Uniform Partings	40	
Finished Style/ Technique	60	
Total Points	400	

*If the exhibit is rated less than Qualified for State or Superior, then the judges should explain why below:

Judges Remarks

Score	STATE
360 - 400	Superior
320 – 359	Excellent
280 – 319	Very Good
0 - 279	N/A

**State Registration Sticker
Should Be Placed Here**

Cosmetology - Day and Evening Hair Design Job Exhibit Project Rating Sheet-State

Please place a blank copy of the rating sheet for each project entry at the front of the report folder. This is an individual contest only.



Maximum Dimension: Base 24" X 24" X Height 24"

The completed district notebook grading sheet with registration sticker and state qualifying stamp should be included in the notebook for state submission with the project. This rating sheet is for the project only at state which will be added to the district notebook grade.

Purpose: To evaluate contestant's mastery of entry-level job skills and to recognize outstanding students for excellence and professionalism in the field of hair design.

Student level: (circle one) 9th 10th 11th 12th

Day and Evening	MAX POINTS	POINTS EARNED
Notebook: Enter Score from Job Exhibit Notebook Rating Sheet	200	
Originality/Design	60	
Smoothness	40	
Balance	40	
Overall Finished Style	60	
Total Points	400	

*If the exhibit is rated less than Qualified for State or Superior, then the judges should explain why
Judges Remarks:

Score	STATE
360 - 400	Superior
320 – 359	Excellent
280 – 319	Very Good
0 - 279	N/A

**State Registration Sticker
Should Be Placed Here**

Cosmetology – Fantasy Job Exhibit Project Rating Sheet-State

Please place a blank copy of the rating sheet for each project entry at the front of the report folder. This is an individual contest only.

Maximum Dimension: Base 24" x 24" Height 24"



The completed district notebook grading sheet with registration sticker and state qualifying stamp should be included in the notebook for state submission with the project. This rating sheet is for the project only at state which will be added to the district notebook grade.

Purpose: To evaluate contestant's mastery of entry-level job skills and to recognize outstanding students for excellence and professionalism in the field of hair design.

Student level: (circle one) 9th 10th 11th 12th

FANTASY	MAX POINTS	POINTS EARNED
Notebook: Enter Score from Job Exhibit Notebook Rating Sheet	200	
Movement	60	
Smoothness	40	
Creativity	60	
Balanced	40	
Total Points	400	

*If the exhibit is rated less than Qualified for State or Superior, then the judges should explain why below:

Judges Remarks:

Score	STATE
360 - 400	Superior
320 – 359	Excellent
280 – 319	Very Good
0 - 279	N/A

**State Registration Sticker
Should Be Placed Here**

Cosmetology – Men’s Classic Cut Job Exhibit Project Rating Sheet- State



Please place a blank copy of the rating sheet for each project entry at the front of the report folder. This is an individual contest only.

Maximum Dimension: Base 24" x 24" Height 24"

The completed district notebook grading sheet with registration sticker and state qualifying stamp should be included in the notebook for state submission with the project. This rating sheet is for the project only at state which will be added to the district notebook grade.

Purpose: To evaluate contestant's mastery of entry level job skills and to recognize outstanding students for excellence and professionalism in the field of classic cut.

Student level: (circle one) 9th 10th 11th 12th

Men’s Classic Cut	MAX POINTS	POINTS EARNED
Notebook: Enter Score from Job Exhibit Notebook Rating Sheet	200	
Precision of/blending/tapering	40	
Clean Fade Neck Line/outline	40	
Detail of cut	60	
Finished Style	60	
Total Points	400	

*If the exhibit is rated less than Qualified for State or Superior, then the judges should explain why below:

Judges Remarks:

Score	STATE
360 - 400	Superior
320 – 359	Excellent
280 – 319	Very Good
0 - 279	N/A

**State Registration Sticker
Should Be Placed Here**

Cosmetology - Men's Design Cut Job Exhibit Project Rating Sheet-State

Please place a blank copy of the rating sheet for each project entry at the front of the report folder. This is an individual contest only.

Maximum Dimension: Base 24" x 24" Height 24"



The completed district notebook grading sheet with registration sticker and state qualifying stamp should be included in the notebook for state submission with the project. This rating sheet is for the project only at state which will be added to the district notebook grade.

Purpose: To evaluate contestant's mastery of entry-level job skills and to recognize outstanding students for excellence and professionalism in the field of Men's Design Cut.

Student level: (circle one) 9th 10th 11th 12th

Men's Design Cut	MAX POINTS	POINTS EARNED
Notebook: Enter Score from Job Exhibit Notebook Rating Sheet	200	
Creativity of Design	60	
Clean Lines / Fading	40	
Techniques/Tapering	40	
Overall Style	60	
Total Points	400	

*If the exhibit is rated less than Qualified for State or Superior, then the judges should explain why below:

Judges Remarks:

Score	STATE
360 - 400	Superior
320 - 359	Excellent
280 - 319	Very Good
0 - 279	N/A

**State Registration Sticker
Should Be Placed Here**

Cosmetology – Flat Nail Art Job Exhibit Project Rating Sheet-State

Please place a blank copy of the rating sheet for each project entry at the front of the report folder. This is an individual contest only.

Maximum Dimension: Base 15" X 12" X Height 12" 5 NAILS ONLY

The completed district notebook grading sheet with registration sticker and state qualifying stamp should be included in the notebook for state submission with the project. This rating sheet is for the project only at state which will be added to the district notebook grade.



Purpose: To evaluate contestant's mastery of entry-level job skills and to recognize outstanding students for excellence and professionalism in the field of nail art.

Student level: (circle one) 9th 10th 11th 12th

Flat Nail Art	MAX POINTS	POINTS EARNED
Notebook: Enter Score from Job Exhibit Notebook Rating Sheet	200	
Creativity of Design	60	
Detail of Application, verify no prohibited materials used	40	
Flow of Theme	40	
Overall Appearance of Display	60	
Total Points	400	

*If the exhibit is rated less than Qualified for State or Superior, then the judges should explain why

Judges Remarks:

The following are NOT allowed, if they are the project will be disqualified and not be judged:

- | | | |
|------------------|------------|-----------------------|
| • GEMS | • GLITTERS | • STAMPING PLATES |
| • SKINS | • THREADS | • JEWELRY |
| • FEATHERS | • FABRICS | • DECALS |
| • RHINESTONES | • FOILS | • CAST MOLDING, |
| • CRYSTALS | • BEADS | • 3-DIMENSIONAL FORMS |
| • TRANSFER FOILS | • TAPES | • STENCILS |

Score	STATE
360 - 400	Superior
320 – 359	Excellent
280 – 319	Very Good
0 - 279	N/A

**State Registration Sticker
Should Be Placed Here**

Cosmetology – Nail Art 3D Job Exhibit Project Rating Sheet-State

Please place a blank copy of the rating sheet for each project entry at the front of the report folder. This is an individual contest only.

Maximum Dimension: Base 15" X 12" X Height 12" 5 NAILS ONLY

The completed district notebook grading sheet with registration sticker and state qualifying stamp should be included in the notebook for state submission with the project. This rating sheet is for the project only at state which will be added to the district notebook grade.



Purpose: To evaluate contestant's mastery of entry-level job skills and to recognize outstanding students for excellence and professionalism in the field of 3D nail art.

Student level: (circle one) 9th 10th 11th 12th

Nail Art 3D	MAX POINTS	POINTS EARNED
Notebook: Enter Score from Job Exhibit Notebook Rating Sheet	200	
Creativity	60	
Detail of Application, no prohibited items used	40	
Clarity of Design	40	
Overall Appearance of Display	60	
Total Points	400	

*If the exhibit is rated less than Qualified for State or Superior, then the judges should explain why

Judges Remarks:

The following are NOT allowed, if they are used the project will be disqualified and not be judged:

- | | | |
|--|--|---|
| <ul style="list-style-type: none"> • GEMS • SKINS • FEATHERS • RHINESTONES • TRANSFER FOILS | <ul style="list-style-type: none"> • GLITTERS • THREADS • FABRICS • FOILS • BEADS • TAPES • STAMPING PLATES • CRYSTALS | <ul style="list-style-type: none"> • JEWELRY • PAINTS • POLISH LACQUERS • GELS • MOLDS • STENCILS |
|--|--|---|

Score	STATE
360 - 400	Superior
320 – 359	Excellent
280 – 319	Very Good
0 - 279	N/A

**State Registration Sticker
Should Be Placed Here**

Cosmetology – Salon Job Exhibit Project Rating Sheet-State

Please place a blank copy of the rating sheet for each project entry at the front of the report folder.

Dimensions: 24" x 36" max, 12" Height max per story, 2 story max

To evaluate mastery of entry-level job skills and to recognize outstanding students for excellence and professionalism in entrepreneurship or salon business. The completed district notebook grading sheet with registration sticker and state qualifying stamp should be included in the notebook for state submission with the project. This rating sheet is for the project only at state which will be added to the district notebook grade.

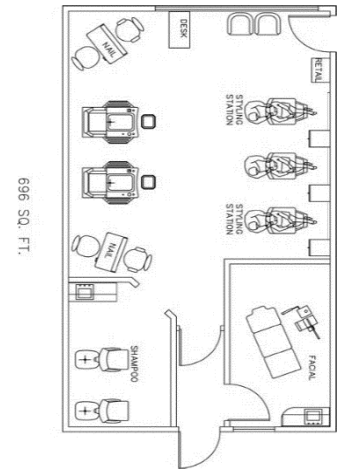

(circle one): Individual Team of 2 (circle one) 1 story 2 story

(circle one per contestant): 9th 10th 11th 12th

Salon Model Project	Max Points	Points earned
Notebook: Enter Score from Job Exhibit Notebook Rating Sheet	200	
Design & Originality	60	
Detail	50	
Construction	40	
Overall Model	50	
Total Points 400		

*If the exhibit is rated less than Qualified for State or Superior, then the judges should explain why
Judges Remarks:

Score	STATE
360 - 400	Superior
320 – 359	Excellent
280 – 319	Very Good
0 - 279	N/A

**State Registration Sticker
Should Be Placed Here**

Cosmetology - Women's Edge Cut & Color Job Exhibit Project Rating Sheet-State

Please place a blank copy of the rating sheet for each project entry at the front of the report folder. This is an individual contest only.

Purpose: To evaluate contestant's mastery of entry-level job skills and to recognize outstanding students for excellence and professionalism in the field of Women's Cutting Edge Cut & Color.



Maximum Dimension: Base 24" x 24" Height 24"

The completed district notebook grading sheet with registration sticker and state qualifying stamp should be included in the notebook for state submission with the project. This rating sheet is for the project only at state which will be added to the district notebook grade.

Student level: (circle one) 9th 10th 11th 12th

Women's Edge Cut/Color	MAX POINTS	POINTS EARNED
Notebook: Enter Score from Job Exhibit Notebook Rating Sheet	200	
Creativity	60	
Design/Cut	40	
Detail/Color	40	
Overall Style	60	
Total Points	400	

*If the exhibit is rated less than Qualified for State or Superior, then the judges should explain why
Judges Remarks:

Score	STATE
360 - 400	Superior
320 - 359	Excellent
280 - 319	Very Good
0 - 279	N/A

**State Registration Sticker
Should Be Placed Here**

Criminal Justice – Crime Scene Model Job Exhibit

PURPOSE

The Criminal Justice Crime Scene Model is designed to encourage students currently enrolled in a criminal justice or law enforcement CTE program to enter a model of a crime scene ***illustrating technical skills learned*** in the criminal justice or law enforcement field.

Eligibility: Student currently enrolled in a criminal justice or law enforcement CTE Program. Each student will be permitted one entry in panel exhibit. This may be a team of 2 or individual display.

NOTE TO ADVISORS

Each chapter advisor will screen each member's model so that model submitted contains outstanding examples of technical skills related to their criminal justice or law enforcement Career and Technical Education program. Representations of deceased victims should be a one-dimensional outline. Any content deemed inappropriate for a school project will be disqualified.

THIS DOCUMENT SHOULD BE THE 2nd ITEM IN YOUR NOTEBOOK AT DISTRICT

RULES

1. The model should be no larger than 24" x 36" max 12" high per story
2. The model must contain 3 dimensional representations of a crime scene location.
3. In the body of the notebook a detailed step by step explanation of proper handling of the depicted crime scene should be included.
4. Models are to be student designed, arranged, and completed during the current school year in which the exhibit is to be displayed.
5. The panel will be judged on the standards listed in the score sheet.

All Job Exhibits Require a Notebook. Notebook description is found in this document titled Job Exhibit Notebook. The project notebook should demonstrate core academic abilities. The student should demonstrate the use of proper English, Math, and Science in the project. Academics should be a major emphasis in the notebook.

Criminal Justice – Crime Scene Model Job Exhibit Project Rating Sheet-State

Please place a blank copy of the rating sheet for each project entry at the front of the report folder.

Model Dimensions: 24" x 36" or smaller, 12" high max per story

(circle one) Individual Multiple

The completed district notebook grading sheet with registration sticker and state qualifying stamp should be included in the notebook for state submission with the project. This rating sheet is for the project only at state which will be added to the district notebook grade.

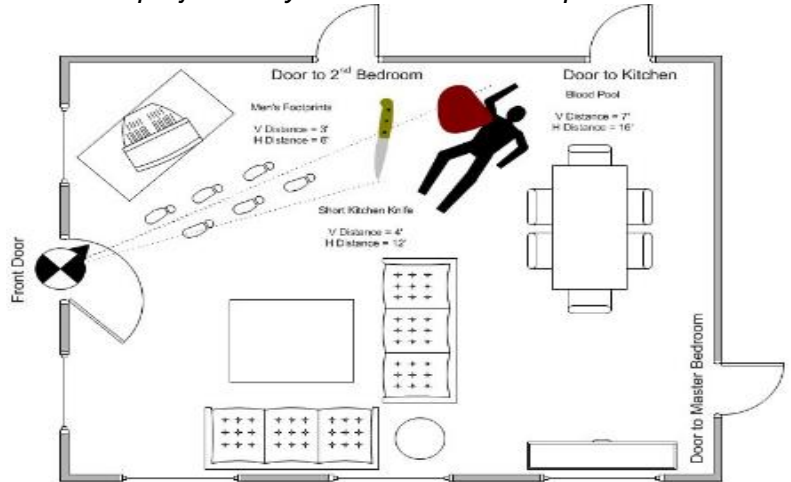

Crime Scene Model Project	Max Points	Points earned
Notebook: Enter Score from Job Exhibit Notebook Rating Sheet	200	
Detail and Documentation	60	
Construction	40	
Proper Terminology and Equipment	50	
All steps in crime scene process depicted in model	50	
Total Points 400		

Remarks:

Score	STATE
360 - 400	Superior
320 – 359	Excellent
280 – 319	Very Good
0 - 279	N/A

**State Registration Sticker
Should Be Placed Here**

Criminal Justice / Law Enforcement Display Panel Job Exhibit

PURPOSE

The Criminal Justice Display Panel is designed to encourage students currently enrolled in a criminal justice or law enforcement CTE program to enter a display **describing a technical skill learned** in the criminal justice or law enforcement field.

Eligibility: Student currently enrolled in a criminal justice or law enforcement CTE Program. Each student will be permitted one entry in panel exhibit. This may be a team of 2 or individual display.

NOTE TO ADVISORS

Each chapter advisor will screen each member's panel so that member panels submitted contain outstanding examples of a technical skill related to their criminal justice or law enforcement Career and Technical Education program. Any content deemed inappropriate for a school project will be disqualified.

THIS DOCUMENT SHOULD BE THE 2nd ITEM IN YOUR NOTEBOOK AT DISTRICT

RULES

6. The panel shall be: a three-panel foam core or cardboard panel no larger than 30" by 60" that is self-supporting with **NO** electrical needs. No other props will be allowed, must fold flat.
7. The panel will consist of 10 or more photographs of the student-performing tasks associated with a specific skill learned in the laboratory class.
8. Typed Explanation of the logical steps in the process of the end product, the display panel, or steps taken to perform the skill being described on the panel. This may be on the panel itself or in the notebook.
9. Resume to be included in the notebook.
10. Panels are to be student designed, arranged, and completed during the current school year in which the exhibit is to be displayed.
11. Documentation will be attached according to the "[Rules and Procedures for Entering Student Exhibit, Student Notebook, and Chapter Contests Entries.](#)"
12. The panel will be judged on the standards listed in the score sheet.

Notebook. Notebook description is found in this document titled Job Exhibit Notebook. The project notebook should demonstrate core academic abilities. The student should demonstrate the use of proper English, Math, and Science in the project. Academics should be a major emphasis in the notebook.

Criminal Justice Display Panel Job Exhibit Project Rating Sheet-State

Please place a copy of the rating sheet for each project entry at the front of the report folder.

a three-panel foam core or cardboard panel

- no larger than 30" by 60" that is
- self-supporting with
- **NO** electrical needs.
- No other props will be allowed,
- must fold flat.

The completed district notebook grading sheet with registration sticker and state qualifying stamp should be included in the notebook for state submission with the project. This rating sheet is for the project only at state which will be added to the district notebook grade.

	Judging Criteria	Points Allowed	Points Awarded
1.	Exhibit Construction – Layout Esthetically Pleasing	40 Points	
2.	Neatness of the panel	60 Points	
3.	Originality	40 Points	
4.	Technical skill displayed is typical to the Criminal Justice/Law Enforcement field	60 Points	
5.	Notebook: Enter Score from Job Exhibit Notebook Rating Sheet	200 Max	
	Total Points	400	

Remarks:

Score	STATE
360 - 400	Superior
320 – 359	Excellent
280 – 319	Very Good
0 - 279	N/A

**State Registration Sticker
Should Be Placed Here**

Digital Illustration Job Exhibit

Purpose

A digital illustration job exhibit is a custom drawn illustration created through the use of digital tools to generate art directly from the artist's hand, usually through a pointing device such as a tablet or a mouse. **This job exhibit should NOT include a company, product or event. This should not be an Advertisement.

Specifications

- Entries must be started and completed during the current school year, beginning no earlier than August 1st.
- All content must be original
- Entry created by only one individual
- May submit only one image
- Each exhibit must include a notebook secured in a binder or folder.

THIS DOCUMENT SHOULD BE THE 2nd ITEM IN YOUR NOTEBOOK AT DISTRICT

Elements & Principles of Design

Each entry should consider and apply basic elements and principles of design, including any of the following:

- Elements: line, shape, color, texture, pattern, value, form
- Principles: contrast, alignment, repetition, proximity, balance, unity, emphasis, rhythm, and proportion

Dimensions

Each submission or print may fill a space no larger than 2' x 2' x 3' when displayed, including matting and display stands.

All Job Exhibits Require a Notebook. Notebook description is found in this document titled Job Exhibit Notebook. The project notebook should demonstrate core academic abilities. The student should demonstrate the use of proper English, Math, and Science in the project. Academics should be a major emphasis in the notebook.

Digital Illustration Job Exhibit Project Rating Sheet-State

Please place a copy of the rating sheet for each project entry at the front of the report folder.

The completed district notebook grading sheet with registration sticker and state qualifying stamp should be included in the notebook for state submission with the project. This rating sheet is for the project only at state which will be added to the district notebook grade.

The judges will judge each entry using the following criteria as a guide, along with their own knowledge of professional advertising.

JUDGING CRITERIA		Maximum Points	Points Awarded
1	Clarity of Message: Is the subject matter of the entry appropriate, timely, well planned, and have a clear intent, and/or theme?	30	
2	Creativity and Originality: Does the entry present creative thought or an original idea? Does it show initiative and/or ingenuity?	40	
3	Impact: How well does the entry capture the attention of the viewer or target?	30	
4	Composition incorporates elements and principles of design: Does the use of line, texture, pattern, form, contrast, color, balance etc. enhance the entry?	40	
5	Skill and Technique: How well is the technical ability of the artist highlighted?	40	
6	Production Quality and Presentation: Does the quality of the entry and workmanship enhance the final appearance of the work? This includes matting and overall neatness of the final project and notebook.	20	
7	Documentation Notebook: Enter Score from Job Exhibit Notebook Rating Sheet	200	
PENALTIES			
1	Copyrighted Material: All content must be original OR royalty free	-20	
2	Dimensions: Entry must fit within a 2' x 2' x 3' space when displayed	-10	
Total Penalties		-30	
400 points possible		TOTAL SCORE	
Note to Judges: If an exhibit is rated less than qualified for state or superior, the judges should explain why below:			
Judges Remarks:			

Score	STATE
360 - 400	Superior
320 – 359	Excellent
280 – 319	Very Good
0 - 279	N/A

**State Registration Sticker
Should Be Placed Here**

Digital Image Manipulation Job Exhibit

Purpose: A digital image manipulation job exhibit is an image that has been digitally edited through technical and creative techniques to apply subtle alterations to an individual image or composite of several images. Edits may include various techniques, including adjustments to color balance or contrast or more complex changes like overlaying a head onto a different body or changing a sign's text. The resulting image may have little or no resemblance to the photo (or photos in the case of compositing) from which it originated. This job exhibit should NOT include a company, product or event.

Categories: Entries may fall into one of the following categories:

1. Technical Retouching

Generally, for photo restoration or enhancement, which may involve the adjustment of colors, contrast, white balance (i.e. gradational retouching) sharpness, and the removal of noise, elements or visible flaws on skin or materials.

2. Creative Manipulation

Creative manipulation could be developed as an art form or for commercial use in fashion, beauty or advertising photography. A large part of creative manipulation can include image compositing whereby the digital artist uses Multiple photos to create a single image, such as changing the background of an image. This kind of image composition is widely used when conventional photography would be technically too difficult or impossible to shoot on location or in studio.

Specifications

- Entries must be started and completed during the current school year, beginning no earlier than August 1st.
- All content must be original
- Entry created by only one individual
- May submit only one image
- Each exhibit must include a notebook secured in a binder or folder.

THIS DOCUMENT SHOULD BE THE 2nd ITEM IN YOUR NOTEBOOK AT DISTRICT

Elements & Principles of Design

Each entry should consider and apply basic elements and principles of design, including any of the following:

- Elements: line, shape, color, texture, pattern, value, form
- Principles: contrast, alignment, repetition, proximity, balance, unity, emphasis, rhythm, and proportion.

Dimensions Each submission or print may fill a space no larger than 2' x 2' x 3' when displayed, including matting and display stands.

All Job Exhibits Require a Notebook. Notebook description is found in this document titled Job Exhibit Notebook. The project notebook should demonstrate core academic abilities. The student should demonstrate the use of proper English, Math, and Science in the project. Academics should be a major emphasis in the notebook.

Digital Image Manipulation Job Exhibit Project Rating Sheet-State

Please place a copy of the rating sheet for each project entry at the front of the report folder.

The completed district notebook grading sheet with registration sticker and state qualifying stamp should be included in the notebook for state submission with the project. This rating sheet is for the project only at state which will be added to the district notebook grade.

The judges will judge each entry using the following criteria as a guide, along with their own knowledge of professional advertising.

JUDGING CRITERIA		Maximum Points	Points Awarded
1	Clarity of Message: Is the subject matter of the entry appropriate, timely, well planned, and have a clear purpose, and/or theme?	30	
2	Creativity and Originality: Does the entry present creative thought or an original idea? Does it show initiative and/or ingenuity?	50	
3	Impact: How well does the entry capture the attention of the viewer or target?	20	
4	Composition incorporates elements and principles of design: Does the use of line, texture, pattern, form, contrast, color, balance etc. enhance the entry?	30	
5	Skill and Technique: How well is the technical ability of the artist highlighted?	40	
6	Production Quality and Presentation: Does the quality of the entry and workmanship enhance the final appearance of the work? This includes matting and overall neatness of the final project and notebook.	30	
7	Documentation (Notebook: Enter Score from Job Exhibit Notebook Rating Sheet	200	
Total Points		400	
PENALTIES			
1	Copyrighted Material: All content must be original	-20	
2	Dimensions: Entry must fit within a 2' x 2' x 3' space when displayed	-10	
Total Penalties		-30	
		TOTAL SCORE	
Judges Remarks:			

Score	STATE
360 - 400	Superior
320 – 359	Excellent
280 – 319	Very Good
0 - 279	N/A

**State Registration Sticker
Should Be Placed Here**

Drafting - Architectural Job Exhibit

All contest drawings should contain the elements of professional drawings, such as title blocks and scales.

Drafting Plan will include:

1. COVER SHEET - Use a perspective or diametric elevation drawing of the house - NOT a school logo. The student's name and school should be on the lower right corner for easy identification.
2. SITE PLAN - Show information about the size of the lot, survey bearings, and the setbacks on all four sides. The roof plan may be used to show the house, but the dimensions should be to the walls not the roof overhang. All sidewalks, driveways and concrete or special features must be dimensioned and labeled.
3. FLOOR PLAN - Show all interior and exterior dimensions sufficient to frame the house. Notes and labels should be placed on all rooms, features, and appliances, plus door and window tags or symbols. Judges like a north arrow placed on this drawing to indicate understanding of passive solar siting. The plan should show evidence of the student's drafting skills and understanding of good design.
4. ELEVATIONS - Four elevations with identifying labels on each, dimensions for grade, line first floor line, ceiling height, second floor line, ceiling height etc. Identify materials on roof and walls, and show roof pitch symbols.
5. ROOF PLAN - Must match elevations and plan. Plan must show details related to roof materials, pitch, overhang, etc.
6. FOUNDATION - Slabs: show perimeter and interior beams, use correct line types, dimensions, labels, and sections. Pier and beam: show pier locations, dimensions, and label the beam materials, size and length. Show detail drawings of slab sections or of piers with dimensions and notes.
7. WINDOW & DOOR SCHEDULE - This may be a chart of sizes and details, or a graphic that shows the doors and windows illustrated on the elevations, sample drawings of interior doors, and the garage doors. Schedule should be accurate and complete. If a graphic is used, show dimension of distance above the floor for windows. Details about the frame, number of panes, and energy efficiency features may be listed below each window. All windows and doors should refer to symbols on the floor plan.

Electric Plan and Wall Sections are no longer required items. These items may be included but will not be graded.

THIS DOCUMENT SHOULD BE THE 2nd ITEM IN YOUR NOTEBOOK AT DISTRICT

All Job Exhibits Require a Notebook. Notebook description is found in this document titled Job Exhibit Notebook. The project notebook should demonstrate core academic abilities. The student should demonstrate the use of proper English, Math, and Science in the project. Academics should be a major emphasis in the notebook.

Architectural Modeling
Civil Engineering

Drafting - Architectural Modeling Job Exhibit Rating Sheet

Please place a copy of the rating sheet for each project entry at the front of the report folder.

The completed district notebook grading sheet with registration sticker and state qualifying stamp should be included in the notebook for state submission with the project. This rating sheet is for the project only at state which will be added to the district notebook grade. Individual, Multiple or chapter.

Judging Criteria		Points Allowed	Points Awarded	Criteria Total
Criteria 1 - Job Occupation (60 Max Points)				
1	What is the level of originality of the work?	0-30 points		
2	What is the level of creativity of the project?	0-30 points		
			C1 Total	
Criteria 2 - Craftsmanship (40 Max Points)				
1	What is the level of neatness and the quality of work?	0-20 points		
2	Is the completed project aesthetically pleasing?	0-10 points		
3	Is there evidence of effort throughout the project's design?	0-10 points		
			C2 Total	
Criteria 3 - Complexity (60 Points Max)				
1	How would you rate the level of difficulty or complexity in the original design or proposal?	0-30 points		
2	Does the level of work in the project reflect the level of difficulty of the overall intended project?	0-30 points		
			C3 Total	
Criteria 4 - Base Model (40 Points Max)				
1	Does the project base have contours?	0-20 points		
2	Are the contours cut clean and smoothly?	0-10 points		
3	Are the contours designed to flow from one level to the next?	0-10 points		
Criteria 5 - Documentation Notebook: Enter Score from Job Exhibit Notebook Rating Sheet max 200 points		0 - 200 points	C4 Total	
			C5 Total	
		400 Total Points		
Judges Remarks:				

Score	STATE
360 - 400	Superior
320 – 359	Excellent
280 – 319	Very Good
0 - 279	N/A

**State Registration Sticker
Should Be Placed Here**

Drafting Civil Engineering Job Exhibit Project Rating Sheet-State

Please place a copy of the rating sheet for each project entry at the front of the report folder.

The completed district notebook grading sheet with registration sticker and state qualifying stamp should be included in the notebook for state submission with the project. This rating sheet is for the project only at state which will be added to the district notebook grade. Individual only.

(All drawings should contain the elements of a professional drawing.)

Judging Criteria	Points Allowed	Points Awarded
Cover Sheet: A cover sheet has been included with the drawing	10	
Subdivision Layout: Proper drafting technique has been used to draw the subdivision. A legend, scale and legal description has been included, lots and blocks, roadways, easements, etc., are included in the drawing.	20	
Linework and Symbology: Proper line weights and line types have been utilized throughout the Subdivision, symbols are correct scale and symbology is accurately depicting features.	60	
Annotation and Dimensions: All appropriate annotations and dimensions have been included throughout the survey, including all bearing and distances, easements, ROWs, road names and lot / block numbers. All text is also located in the correct areas and in the correct directions.	50	
Scale: Drawing, annotation, dimensions, line types and symbols have been scaled correctly and with an appropriate scale.	30	
Legibility and Professionalism: Text, annotation and dimensions are easily identified and are legible. Drawing looks professional and clean, does not look cluttered	30	
Documentation Notebook: Enter Score from Job Exhibit Notebook Rating Sheet max 300 points	200	
Total Points	400	
Note to Judges: If an exhibit is rated less than qualified for state or superior, the judges should explain why below:		
Judges Remarks:		

Score	STATE
360 - 400	Superior
320 – 359	Excellent
280 – 319	Very Good
0 - 279	N/A

**State Registration Sticker
Should Be Placed Here**

Drafting Computer Aided Architectural Job Exhibit

All contest drawings should contain the elements of professional drawings, such as title blocks and scales.

1. COVER SHEET - Use a perspective or diometric elevation drawing of the house - NOT a school logo. (Judges see no value in a school logo on the cover of student's drawings in this contest. Get creative.) The student's name and school should be on the lower right corner for easy identification.
2. SITE PLAN - Show information about the size of the lot, survey bearings, and the setbacks on all four sides. The roof plan may be used to show the house, but the dimensions should be to the walls not the roof overhang. All sidewalks, driveways and concrete or special features must be dimensioned and labeled.
3. FLOOR PLAN - Show all interior and exterior dimensions sufficient to frame the house. Notes and labels should be placed on all rooms, features, and appliances, plus door and window tags or symbols. Judges like a north arrow placed on this drawing to indicate understanding of passive solar siting. The plan should show evidence of the student's drafting skills and understanding of good design.
4. ELEVATIONS - Four elevations with identifying labels on each, dimensions for grade, line first floor line, ceiling height, second floor line, ceiling height etc. Identify materials on roof and walls, and show roof pitch symbols.
5. ROOF PLAN - Must match elevations and plan. Plan must show details related to roof materials, pitch, overhang, etc.
6. FOUNDATION - Slabs: show perimeter and interior beams, use correct line types, dimensions, labels, and sections. Pier and beam: show pier locations, dimensions, and label the beam materials, size and length. Show detail drawings of slab sections or of piers with dimensions and notes.
7. WINDOW & DOOR SCHEDULE - This may be a chart of sizes and details, or a graphic that shows the doors and windows illustrated on the elevations, sample drawings of interior doors, and the garage doors. Schedule should be accurate and complete. If a graphic is used, show dimension of distance above the floor for windows. Details about the frame, number of panes, and energy efficiency features may be listed below each window. All windows and doors should refer to symbols on the floor plan.

Electric Plan and Wall Sections are no longer required items. These items may be included but will not be graded.

THIS DOCUMENT SHOULD BE THE 2nd ITEM IN YOUR NOTEBOOK AT DISTRICT

All Job Exhibits Require a Notebook. Notebook description is found in this document titled Job Exhibit Notebook. The project notebook should demonstrate core academic abilities. The student should demonstrate the use of proper English, Math, and Science in the project. Academics should be a major emphasis in the notebook.

Drafting CAD Architectural Projects – Project Rating Sheet-State

Please place a copy of the rating sheet for each project entry at the front of the report folder.

All drawings should contain the elements of a professional drawing

The completed district notebook grading sheet with registration sticker and state qualifying stamp should be included in the notebook for state submission with the project. This rating sheet is for the project only at state which will be added to the district notebook grade. Individual or Multiple (2-5)

Judging Criteria	Points Allowed	Points Awarded	Criteria Total
COVER SHEET (10 Points)			
Perspective or diametric elevation drawing of the house	1-10		
SITE PLAN (20 Points)			
Shows legal description, the size of the lot and/or survey bearings	1-6		
Location of the house on the lot shown with setback dimensions on all sides	1-4		
Shows dimensions of all sidewalks, driveways, concrete, or special features	1-6		
Labels identify features and help clarify the drawing	1-4		
FLOOR PLAN (60 Points)			
Floor Plans contain elements of good design and meet industry standards	1-20		
Shows all interior and exterior dimensions needed to build the house	1-20		
Labels should be placed on all rooms, doors, windows, features, and appliances	1-10		
Notes are readable and help explain the features, materials, and construction	1-10		
ELEVATIONS (40 Points)			
Each view should be labeled and show dimensions for grade, floor lines, roof pitch, etc. Front	1-10		
Rear	1-10		
Left	1-10		
Right	1-10		
ROOF PLAN (20 Points) Must match elevations and plan	1-10		
Shows details related to roof materials, pitch, overhang, etc.	1-10		
FOUNDATION PLAN (20 Points)			
SLAB: Shows perimeter and interior beam locations (Uses correct line types)	1-6		
Dimensions are readable and organized	1-6		
Labels identify sizes and types of materials	1-4		
Section views are evident and correctly drawn	1-4		
PIER AND BEAM: Pier locations are shown and dimensioned	1-6		
Beams and joists are shown in proper position and quantity	1-6		
Labels indicate materials (wood, engineered wood, etc.), sizes and length.	1-4		
Shows a Detailed drawing of piers with dimensions and notes.	1-4		
WINDOW & DOOR SCHEDULE (30)			
May be chart or graphic, shows details, and references the symbols on floor plan.	0-30		
Notebook: Enter Score from Job Exhibit Notebook Rating Sheet max 200 points	200		
400 Total Points			
Judges Remarks:			

Score	STATE
360 - 400	Superior
320 – 359	Excellent
280 – 319	Very Good
0 - 279	N/A

**State Registration Sticker
Should Be Placed Here**

Drafting Computer Aided Technical Job Exhibit Project Rating Sheet-State

Please place a copy of the rating sheet for each project entry at the front of the report folder.

The completed district notebook grading sheet with registration sticker and state qualifying stamp should be included in the notebook for state submission with the project. This rating sheet is for the project only at state which will be added to the district notebook grade. Individual or Multiple (2-5)

Judging Criteria	Points Allowed	Points Awarded
1. Does the job meet the standards of the occupation as to quality, finish, neatness and is it pleasing in its appearance.	30	
Assembled Drawing <i>The assembled drawing may be included as part of write-up if desired</i>	10	
Scaled Pictorial Drawing <ul style="list-style-type: none"> ○ With <u>Parts List</u> that includes but not limited to: <ul style="list-style-type: none"> ▪ Part Number ▪ Part Name ▪ Amount Required ▪ Type of Material used ○ Drawing may be drawn in exploder isometric, exploded 3D, exploded axonometric, assembled orthographic or other type of pictorial showing how the bubbled parts fit or come together. 	40	
Orthographic (<i>Bubbled Multiple-View</i>) drawing of each piece	80	
2. Does the job show adequate evidence of work performed.	20	
3. Does the job show initiative, study, and/or ingenuity on the part of the contestant?	20	
Notebook: Enter Score from Job Exhibit Notebook Rating Sheet max 300 points	200	
Total Points	400	
Judges Remarks:		

Score	STATE
360 - 400	Superior
320 – 359	Excellent
280 – 319	Very Good
0 - 279	N/A

**State Registration Sticker
Should Be Placed Here**

Drafting – Technical Illustration Job Exhibit

Purpose:

To evaluate each contestant's preparation for employment and to recognize outstanding students for excellence and professionalism in the field of technical drafting.

Eligibility:

Open to active SkillsUSA members enrolled in programs with technical drafting as the occupational objective. Individual or Multiple (2-5)

Project Requirements:

- All contest drawings should contain the elements of professional drawings, such as title blocks and scales. Drawing Plan will include:
- Notebook
- Drawing represent the industry standard definition of Technical Illustration ("A pictorial drawing that provides technical information using visual methods)
- Does the drawing include the use of any of the following: charts, graphs, schematics, flowchart diagrams, or circuit layouts?
- Is the drawing title block and drawing information present?
- Are supporting Notations of Material Type or Location distances (some dimensions) present?
- Is there supporting documentation about where the student got the plans, time to complete the drawing, and type of software used.

THIS DOCUMENT SHOULD BE THE 2nd ITEM IN YOUR NOTEBOOK AT DISTRICT

All Job Exhibits Require a Notebook. Notebook description is found in this document titled Job Exhibit Notebook.

The project notebook should demonstrate core academic abilities. The student should demonstrate the use of proper English, Math, and Science in the project. Academics should be a major emphasis in the notebook.

Drafting Technical Illustration Job Exhibit Project Rating Sheet-State

The completed district notebook grading sheet with registration sticker and state qualifying stamp should be included in the notebook for state submission with the project. This rating sheet is for the project only at state which will be added to the district notebook grade.

The Judge will rate each project in accordance with the following ratings:		Max Points	Points Awarded
1.	Notebook: Enter Score from Job Exhibit Notebook Rating Sheet	200	
2.	Does the drawing represent the industry standard definition of Technical Illustration ("A pictorial drawing that provides technical information using visual methods)	0 - 100	
3.	Does the drafter use proper pictorial methods for a technical illustration (Oblique, Isometric, or Perspective)?	0 - 20	
4.	Does the drawing include the use of any of the following: charts, graphs, schematics, flowchart diagrams, or circuit layouts	0 - 20	
5.	Is the drawing title block and drawing information present?	0 - 20	
6.	Are supporting Notations of Material Type or Location distances (<u>some</u> dimensions) present?	0 - 20	
7.	Is there supporting documentation about where the student got the plans, time to complete the drawing, and type of software used.	0 - 20	
Total Points		400	
Note to Judges: If an exhibit is rated less than qualified for state or superior, the judges should explain why below:			

Score	STATE
360 - 400	Superior
320 – 359	Excellent
280 – 319	Very Good
0 - 279	N/A

**State Registration Sticker
Should Be Placed Here**

Electrical Trades Job Exhibit

Purpose:

To evaluate each contestant's preparation for employment and to recognize outstanding students for excellence and professionalism in the field of electrical trades

Eligibility:

Open to active SkillsUSA members enrolled in programs with electrical trades as the occupational objective.

Project Requirements:

- Notebook
- Is the job exhibit compliant with the current National Electrical Code?
- Does the project clearly depict real world application?
- Does the supporting documentation demonstrate industry standards?
- Is there supporting documentation about where the student got the plans, idea, materials list and steps in the build process?

THIS DOCUMENT SHOULD BE THE 2nd ITEM IN YOUR NOTEBOOK AT DISTRICT

All Job Exhibits Require a Notebook. Notebook description is found in this document titled Job Exhibit Notebook.

The project notebook should demonstrate core academic abilities. The student should demonstrate the use of proper English, Math, and Science in the project. Academics should be a major emphasis in the notebook.

Electrical Trades
Electronic Design
Electronic Kit-Soldering

Electrical Trades Job Exhibit Project Rating Sheet-State

Revised July 2006 by Teachers of Electrical Trades/Technology in Public Schools TOETTIP

Circle One Residential Commercial

Circle One: Individual Multiple Chapter

Size: The Job Exhibit is limited to 4 feet by 8 feet. The service riser will not exceed 10 feet. A service pole will not exceed 10 feet

Notebook description is found in this document titled Job Exhibit Notebook.

The completed district notebook grading sheet with registration sticker and state qualifying stamp should be included in the notebook for state submission with the project. This rating sheet is for the project only at state which will be added to the district notebook grade.

Judging Criteria	Points Allowed	Points Awarded
1. Notebook: Enter Score from Job Exhibit Notebook Rating Sheet	200	
2. Accuracy with which the job exhibit meets specifications and description with the job, and has evidence of the work performed.	40	
3. The job exhibit meets the industry standard for creativity and neatness.	40	
4. The job exhibit is compliant with the current National Electrical Code NFPA Publication 70.	50	
5. The job exhibit will be judged on the degree of difficulty.	10	
6. The job exhibit represents the field of study.	10	
Total Points	400	
Judges Remarks:		

Score	STATE
360 - 400	Superior
320 – 359	Excellent
280 – 319	Very Good
0 - 279	N/A

**State Registration Sticker
Should Be Placed Here**

Electronic Design Job Exhibit Project Rating Sheet-State

The purpose of this job exhibit is to produce a project that represents skills learned in the use of electronics. Bread boards, or Arduino boards can be used as an example to demonstrate the use of Electronic design concepts. Individual or Multiple (2-5)

All Job Exhibits Require a Notebook. Notebook description is found in this document titled Job Exhibit Notebook. The project notebook should demonstrate core academic abilities. The student should demonstrate the use of proper English, Math, and Science in the project. Academics and documentation should be a major emphasis in the notebook.

The completed district notebook grading sheet with registration sticker and state qualifying stamp should be included in the notebook for state submission with the project. This rating sheet is for the project only at state which will be added to the district notebook grade.

Please place a copy of the rating sheet for each project entry at the front of the report folder.

Judging Criteria	Points Allowed	Points Awarded
1. Is this project a good representation of either a real-world application or a design spec?	50	
2. Does this project demonstrate originality, in depth thought process, innovation, and evolution of design?	50	
3. Does the project meet the standards of quality, finish, safety, neatness, and professional in appearance?	50	
4. Is there evidence of a display board that clearly communicates an overall summary of the design	50	
5. Notebook: Enter Score from Job Exhibit Notebook Rating Sheet	200	
Total Points	400	
*If an exhibit is rated less than qualified for state or superior, then the judges should explain why below:		

Score	STATE
360 - 400	Superior
320 – 359	Excellent
280 – 319	Very Good
0 - 279	N/A

**State Registration Sticker
Should Be Placed Here**

Electronic Kit Job Exhibit Project Rating Sheet-State

The purpose of this job exhibit is to produce a project that represents skills learned in the use of electronics through Soldering. Soldering kits can be used to create these projects.

Individual or Multiple (2-5)

All Job Exhibits Require a Notebook. Notebook description is found in this document titled Job Exhibit Notebook. The project notebook should demonstrate core academic abilities. The student should demonstrate the use of proper English, Math, and Science in the project. Academics and documentation should be a major emphasis in the notebook.

The completed district notebook grading sheet with registration sticker and state qualifying stamp should be included in the notebook for state submission with the project. This rating sheet is for the project only at state which will be added to the district notebook grade.

Please place a copy of the rating sheet for each project entry at the front of the report folder.

Judging Criteria	Points Allowed	Points Awarded
1. Does the project kit represent the electronic career areas?	50	
2. Does this project demonstrate in depth thought process through one or more of the following? a. Programming b. Alignment c. A combination of kits combined together to perform a realistic application and/or other improvements	50	
3. Does the project meet the standards of quality, finish, safety, neatness and professional in appearance?	100	
4. Notebook: Enter Score from Job Exhibit Notebook Rating Sheet	200	
Total Points	400	
*If an exhibit is rated less than qualified for state or superior, then the judges should explain why below:		

Score	STATE
360 - 400	Superior
320 – 359	Excellent
280 – 319	Very Good
0 - 279	N/A

**State Registration Sticker
Should Be Placed Here**

Engineering Related Job Exhibit Project Rating Sheet-State

The purpose of this job exhibit is to produce a project that represents skills learned in the use of Engineering. Robotics, Raspberry Pi designs, engineering design prototypes and any engineering concepts can be presented in these projects.

All Job Exhibits Require a Notebook. Notebook description is found in this document titled Job Exhibit Notebook. The project notebook should demonstrate core academic abilities. The student should demonstrate the use of proper English, Math, and Science in the project. Academics should be a major emphasis in the notebook.

The completed district notebook grading sheet with registration sticker and state qualifying stamp should be included in the notebook for state submission with the project. This rating sheet is for the project only at state which will be added to the district notebook grade.

Please place a copy of the rating sheet for each project entry at the front of the report folder.

THIS DOCUMENT SHOULD BE THE 2nd ITEM IN YOUR NOTEBOOK AT DISTRICT

Judging Criteria	Points Allowed	Points Awarded
1. Is this project a good representation of either a real-world application or a design spec for a clearly stated engineering discipline?	50	
2. Does this project demonstrate originality, in depth thought process, innovation, and evolution of design?	50	
3. Does the project meet the standards of quality, finish, safety, neatness and professional in appearance?	100	
4. Notebook: Enter Score from Job Exhibit Notebook Rating Sheet	200	
Total Points	400	
*If an exhibit is rated less than qualified for state or superior, then the judges should explain why below:		

Score	STATE
360 - 400	Superior
320 – 359	Excellent
280 – 319	Very Good
0 - 279	N/A

**State Registration Sticker
Should Be Placed Here**

Fashion Design Job Exhibit

OVERVIEW

Students have the opportunity to research, develop, and create garment designs, garment mock-ups, and portfolios.

PURPOSE

Humans need protection from weather, environmental factors, occupational hazards, and other adversarial conditions. Clothing is designed and worn for utilitarian purposes, decoration, identification, status, and modesty. Student will demonstrate an understanding of and expertise in using design and technology processes to convey a fashion concept.

ELIGIBILITY

- Entries are limited to student in a program that has fashion design as part of the occupational objective. Any type of garment design that is typical of responsible clothing design and creation is considered appropriate.
- Job Exhibit must be designed, sketched, computer-drawn, developed, and sewn by students.
- All garments must be the original work of the students.
- Any portfolio or garment that depicts inappropriate or unacceptable designs will be disqualified.

THIS DOCUMENT SHOULD BE THE 2nd ITEM IN YOUR NOTEBOOK AT DISTRICT

TIME LIMITS

Entries must be started and completed during the current school year.

All Job Exhibits Require a Notebook. Notebook description is found in this document titled Job Exhibit Notebook. The project notebook should demonstrate core academic abilities. The student should demonstrate the use of proper English, Math, and Science in the project. Academics should be a major emphasis in the notebook.

Fashion Design Job Exhibit Project Rating Sheet-State

Please place a copy of the rating sheet for each project entry at the front of the report folder.

The completed district notebook grading sheet with registration sticker and state qualifying stamp should be included in the notebook for state submission with the project. This rating sheet is for the project only at state which will be added to the district notebook grade.

Notebook Components				Points Awarded
Portfolio (120 points)	Minimal Performance 1-8 points	Adequate Performance 9-16 points	Exemplary Performance 17-20 points	
Summary of research	The summary is too brief & lacks the appropriate details expected.	The summary of the research is sufficient; most of the key details are included.	The summary is organized, clear, & concise, with appropriate & necessary	
Interpretation of theme	The interpretation of the theme is very weak & unconvincing.	The interpretation of the theme is clear, with some appropriate justification.	The interpretation of the theme is clear, concise, & thorough, with convincing justification.	
Explanation of garment types	The explanation is unclear, poorly organized, & does not accurately describe the garment types.	The explanation is loosely organized, with adequate attempts to describe the garment types & their production.	The explanation is clear & concise & demonstrates extensive knowledge of garment types & production.	
Design process sketches	Sketches are poorly executed & lack necessary details in the design process.	Sketches are complete & include most notations & references to the design process.	Sketches are well executed, organized, & clearly represent the design process.	
Computer drawings for final design	Computer drawings fail to accurately portray the final design; there are major omissions of important details.	Computer drawings somewhat accurately illustrate the final design, with many important details included.	Computer drawings of the final design are clear, accurate, & effectively portray the final product.	
Documentation	Little evidence of work progress or timing	Somewhat appropriate evidence of work progress or timing	Excellent evidence of work progress or timing	
Quality of Garment (80 points)	Minimal Performance 1-8 points	Adequate Performance 9-16 points	Exemplary Performance 17-20 points	
Proper sewing techniques used/evident	Garment construction fails to meet accepted standards & techniques of construction in relation to the fabric.	Garment construction meets acceptable standards & construction techniques	Garments show that a variety of appropriate techniques were used in the construction.	
Quality fabric & lining	The quality of the fabric & lining is not appropriate for the garments & style representing the interpretation of the theme.	The quality of the fabric & lining is acceptable in presenting the interpretation of the theme.	The quality of the fabric & lining exemplifies the interpretation of the theme & the appearance of the final garments.	
Use of notions	Little or no use of notions is evident in the garments. <i>(buttons, zippers, snaps, embroidery, embellishments, etc.)</i>	An adequate choice & variety of notions are appropriately used in the garments	An excellent choice & variety of notions are used that enhance the overall appearance & quality of the garments.	
Garments Displayed Properly	Garments are not pressed or arranged in an appropriate manner.	Garments are pressed & arranged somewhat appropriately.	Garments are pressed & arranged for display in a garment bag or on a dressmaker mannequin in a professional manner.	
Notebook: Enter Score from Job Exhibit Notebook Rating Sheet Max 200 points				
400 Max TOTAL POINTS				
Judges Remarks:				

Score	STATE
360 - 400	Superior
320 – 359	Excellent
280 – 319	Very Good
0 - 279	N/A

**State Registration Sticker
Should Be Placed Here**

Graphic Communications Digital Offset Job Exhibit Rating Sheet-State

Please place a copy of the rating sheet (page 1&2) for each project entry at the front of the report folder.

THIS DOCUMENT SHOULD BE THE 2nd ITEM IN YOUR NOTEBOOK AT DISTRICT

(Check One) Traditional Including Stripping and Film OR CTP with Poly Plates

All Job Exhibits Require a Notebook. Notebook description is found in this document titled Job Exhibit Notebook. The project notebook should demonstrate core academic abilities. The student should demonstrate the use of proper English, Math, and Science in the project. Academics and documentation should be a major emphasis in the notebook. The completed district notebook grading sheet with registration sticker and state qualifying stamp should be included in the notebook for state submission with the project. This rating sheet is for the project only at state which will be added to the district notebook grade. Individual or Multiple (2-5)

Offset Job Exhibit Rating Sheet Judging Criteria	Max Points	Points Awarded
Layout & Mechanicals	Max 28	
Does the project meet specifications indicated by order of procedure?	4	
Is the layout neat and clean?	4	
Are Multiple thumbnails present? Is chosen one identified?	4	
Is the rough draft present? Is it reflective of the chosen thumbnail?	4	
Is the comprehensive present? Is it reflective of the thumbnail and rough? Is it detailed?	4	
Is the artwork positioned and attached in an appropriate manner on manual layout?	4	
Are thumbnails, roughs and comprehensive labeled with a headline?	4	
Plates and or Flats	Max 42	
Are the plates appropriate for the type of project? And or flats?	14	
Are the images properly positioned on the plate? And or flats?	14	
Are the plates properly exposed and processed? And or flats?	14	
Typography	Max 48	
Is the work free of widows and orphans?(spit text; one word on a line)	6	
Is proper use of leading evident?	6	
Are appropriate font sizes used for body type and headlines?	6	
Is there evidence that the project has been proof read?	6	
Is the type of fonts used appropriate for type of project? Is all type legible?	6	
Is the type usage balanced?	6	
Is the type used correctly, spacing, special effect, shading, positioning?	6	
Are sans serif, serif and decorative fonts used correctly?	6	
TOTAL PAGE 1		

Graphic Communications – Offset Page 2 Press	Max 42	
Is the overall project quality present for type of equipment used to produce?	6	
Is the project printing in proper position?	6	
Is the project printed in register where appropriate?	6	
Is the document free of any pixilation?	6	
Was proper stock size used with no evidence of excessive waste?	6	
If project has bleeds, have they been used appropriately? Are bleed marks used?	6	
Are the ink choices consistent with the order of procedure? CMYK or spot stated?	6	
Bindery	Max 20	
Is the project trimmed to final size as indicated by order of procedure?	4	
Were trim marks used?	4	
Is the project finished by process as acceptable by industry appropriate for this job?	4	
If the stock is cut, are specifications listed in order of procedure?	4	
Is the project folded, glued, stapled, scored or bound as described in order of procedure?	4	
Presentation	Max 20	
Are all required components labeled properly and visible?	4	
Are Thumbnails present and neat (minimum 3)?	4	
Is the Rough Draft present, neat and labeled?	4	
Is the Comprehensive present, neat and labeled?	4	
Is the overall presentation of the exhibit neat, clean and organized?	4	
Notebook: Enter Score from Job Exhibit Notebook Rating Sheet Max 200 points	200	
TOTAL PAGE 2		
Max Total 400 points TOTAL PAGE 1 & PAGE 2		
Judges Remarks:		

Group projects must include a minimum of four original pieces. All pieces must be part of a cohesive campaign and must include documentation of EACH person's work.

Score	STATE
360 - 400	Superior
320 – 359	Excellent
280 – 319	Very Good
0 - 279	N/A

**State Registration Sticker
Should Be Placed Here**

Graphic Communications – Digital Job Exhibit Project Rating Sheet-State

Digital Project – Digital Output Revised - October 2011 Page 1

Please place a copy of the rating sheet for each project entry at the front of the report folder.

The completed district notebook grading sheet with registration sticker and state qualifying stamp should be included in the notebook for state submission with the project. This rating sheet is for the project only at state which will be added to the district notebook grade. Individual or Multiple (2-5)

Judging Criteria	Points Allowed	Points Awarded
Layout & Mechanicals	Max 36	
Does the project meet specifications indicated by order of procedure?	6	
Do the thumbnails show variety offered in layout styles?	6	
Does the comprehensive offer all information needed to design the job?	6	
Are sketches neat and clean?	6	
Is the original (circled) thumbnail design carried all the way through to final piece / layout?	6	
Does the layout match the rough draft?	6	
Computer Elements	Max 48	
Is there evidence that the job was created in a computer graphics Software program?	8	
Does the document include copyright free / original artwork?	8	
Are elements properly aligned in relation to each other?	8	
Are margins balanced?	8	
Are the colors used appropriate using basic color theory rules?	8	
Are the colors listed and used appropriately for the type of design (Spot/CMYK)?	8	
Typography	Max 30	
Is the work free of widows and orphans? (split text; one word on a line)	6	
Is proper use of leading evident?	6	
Are appropriate font sizes used for body type and headlines?	6	
Is there evidence that the project has been proof read?	6	
Are sans serif, serif and decorative fonts used correctly?	6	
Digital Output	Max 42	
Is the overall project quality present for type of equipment used to produce?	6	
Is the project printing in proper position?	6	
Is the project printed in register where appropriate?	6	
Is the document free of any pixilation?	6	
Was proper stock size used with no evidence of excessive waste?	6	
If the stock is cut, are specifications listed in order of procedure?	6	
If project has bleeds, have they been used appropriately? Are bleed marks used?	6	
Bindery	Max 8	
Is the project trimmed to final size as indicated by order of procedure?	4	
Is the project folded, glued, stapled, scored or bound as described in order of procedure?	4	
TOTAL PAGE 1		

Graphic Communications – Digital Job Exhibit Page 2

Judging Criteria	Points Allowed	Points Awarded
Presentation	Max 36	
Are all required components labeled properly and visible?	6	
Are Thumbnails present and neat (minimum 3)?	6	
Is the Rough Draft present, neat and labeled?	6	
Is the Comprehensive present, neat and labeled?	6	
Is the overall presentation of the exhibit neat, clean and organized?	6	
Is the overall presentation clutter free and aesthetically pleasing?	6	
Notebook: Enter Score from Job Exhibit Notebook Rating Sheet Max 200 points		
TOTAL PAGE 2		
Max 400 points TOTAL PAGE 1 & PAGE 2		
*If an exhibit is rated less than qualified for state or superior, then the judges should explain why below:		

THIS DOCUMENT SHOULD BE THE 2nd ITEM IN YOUR NOTEBOOK AT DISTRICT

Group projects must include a minimum of four original pieces. All pieces must be part of a cohesive campaign and must include documentation of EACH person's work.

Score	STATE
360 - 400	Superior
320 – 359	Excellent
280 – 319	Very Good
0 - 279	N/A

**State Registration Sticker
Should Be Placed Here**

Health Sciences Display Panel Job Exhibit

PURPOSE

The Health Sciences Display Panel is designed to encourage students currently enrolled in a health occupations/sciences CTE program to enter a display **describing a technical skill learned** in their health field program.

Eligibility: Student currently enrolled in a health occupations/sciences CTE Program. Each student will be permitted one entry in panel exhibit. This may be a team of 2 or individual display.

NOTE TO ADVISORS

Each chapter advisor will screen each member's panel so the panels submitted contain outstanding examples of a technical skill related to their health occupations/sciences Career and Technical Education program. Any content deemed inappropriate for a school project will be disqualified. The following are prohibited: flames, body fluids, living organisms, sharps, or any equipment/materials that could expose anyone to risk of bodily harm or danger. Invasive procedures and skin puncturing of any kind are prohibited.

THIS DOCUMENT SHOULD BE THE 2nd ITEM IN YOUR NOTEBOOK AT DISTRICT

RULES

1. The panel shall be: a three-panel foam core or cardboard panel no larger than 30" by 60" that is self-supporting with **NO** electrical needs. No other props will be allowed, must fold flat. Computers, electronics, solar power, batteries, or electricity of any kind, may NOT be used.
2. The panel will consist of 10 or more photographs of the student-performing tasks associated with a specific skill learned in the health class.
3. In the body of the notebook a typed explanation of the logical steps in the process of the end product, the display panel, or steps taken to perform the skill being described on the panel.
4. The display should inform others about the career or career cluster, such as but not limited to:
 - a. Job responsibilities
 - b. Education requirements or entry level salary
 - c. Benefits/challenges associated with this career
5. Panels are to be student designed, arranged, and completed during the current school year in which the exhibit is to be displayed.
6. The panel will be judged on the standards listed in the score sheet.

All Job Exhibits Require a Notebook. Notebook description is found in this document titled Job Exhibit Notebook. The project notebook should demonstrate core academic abilities. The student should demonstrate the use of proper English, Math, and Science in the project. Academics should be a major emphasis in the notebook.

Health Sciences Display Panel Job Exhibit Project Rating Sheet-State

Please place a copy of the rating sheet for each project entry at the front of the report folder.

- a three-panel foam core or cardboard panel
- no larger than 30" by 60" that is
- self-supporting with
- **NO** electrical needs.
- No other props will be allowed,
- must fold flat.

The completed district notebook grading sheet with registration sticker and state qualifying stamp should be included in the notebook for state submission with the project. This rating sheet is for the project only at state which will be added to the district notebook grade.

	Judging Criteria	Points Allowed	Points Awarded
1.	Exhibit Construction – Layout Esthetically Pleasing	40 Points	
2.	Neatness of the Panel, Clarity of Task/Skill, Safe Practices Noted	60 Points	
3.	Originality and Quality of information	40 Points	
4.	Technical skill displayed is typical to the health field	60 Points	
5.	Notebook: Enter Score from Job Exhibit Notebook Rating Sheet	200 Max	
	Total Points	400	

Remarks:

Score	STATE
360 - 400	Superior
320 – 359	Excellent
280 – 319	Very Good
0 - 279	N/A

**State Registration Sticker
Should Be Placed Here**

Heating, Ventilation, AC, Refrigeration Job Exhibit Project Rating Sheet-State

Purpose

A job exhibit that demonstrates HCVAR skills.

THIS DOCUMENT SHOULD BE THE 2nd ITEM IN YOUR NOTEBOOK AT DISTRICT

Notebook to be included with all exhibits:

The project notebook should demonstrate core academic abilities. The student should demonstrate the use of proper English, Math, and Science in the project. Academics should be a major emphasis in the notebook.

Please place a copy of the rating sheet for each project entry at the front of the report folder.

The completed district notebook grading sheet with registration sticker and state qualifying stamp should be included in the notebook for state submission with the project. This rating sheet is for the project only at state which will be added to the district notebook grade.

Judging Criteria	Points Allowed	Points Awarded
1. Is the job typical of the occupation, and does the job show originality and initiative and/or ingenuity on the part of the contestant?	20	
2. Does the job accurately meet the specifications or description submitted with the job, and does it have adequate evidence of the work performed.	20	
3. Does the job meet the standards of the occupation for quality, finish, neatness, pleasing in appearance?	40	
A. Quality	20	
B. Finish	10	
C. Neatness	20	
D. Pleasing in appearance	20	
4. Does the job indicate that considerable study and effort was expended? In its design (if applicable), construction, assembly and/or arrangement.	50	
5. Notebook: Enter Score from Job Exhibit Notebook Rating Sheet	200	
Note to Judges: If an exhibit is rated less than qualified for state or superior, the judges should explain below:		
TOTAL SCORE 400 points possible		

Judges Remarks:

Score	STATE
360 - 400	Superior
320 - 359	Excellent
280 - 319	Very Good
0 - 279	N/A

**State Registration Sticker
Should Be Placed Here**

Innovative Job Exhibits Project Rating Sheet-State

Eligibility

Innovative Project is open to all SkillsUSA Texas Members in an approved CTE program. Innovative job exhibits are ground-breaking, pioneering, original, introducing something new, a new way of doing something or the act of inventing.

All Job Exhibits Require a Notebook. Notebook description is found in this document titled Job Exhibit Notebook. The project notebook should demonstrate core academic abilities. The student should demonstrate the use of proper English, Math, and Science in the project. Academics should be a major emphasis in the notebook.

The completed district notebook grading sheet with registration sticker and state qualifying stamp should be included in the notebook for state submission with the project. This rating sheet is for the project only at state which will be added to the district notebook grade.

Please place a copy of the rating sheet for each project entry at the front of the report folder

THIS DOCUMENT SHOULD BE THE 2nd ITEM IN YOUR NOTEBOOK AT DISTRICT

Occupational Area _____ **Circle One: Individual Multiple Chapter**

Judging Criteria	Possible Points	Awarded Points
Does the project meet the definition of innovative? Groundbreaking, pioneering, original, the act of inventing or introducing something new or a new method or idea.	0 – 150	
Is the project related to the occupational field?	0 – 50	
Notebook: Enter Score from Job Exhibit Notebook Rating Sheet Max 300 points	0-200	
Student narrative should include <ul style="list-style-type: none"> i. Originality - Why this project is considered innovative ii. How it is relevant to the occupational field iii. Quality of work - Steps taken to produce this exhibit iv. Core academic relationship v. Team work (if applicable) vi. Technology used 		
Original parts invoice with current dates		
Total Points	400	
*If an exhibit is rated less than qualified for state or superior, then the judges should explain why below:		
Judges Remarks:		

Score	STATE
360 - 400	Superior
320 – 359	Excellent
280 – 319	Very Good
0 - 279	N/A

**State Registration Sticker
Should Be Placed Here**

Interior Design Job Exhibit

added 2019

OVERVIEW

Students have the opportunity to research, develop, and create interior designs, mock-ups, and portfolios.

PURPOSE

Humans need interior spaces that are appropriate for their situation, health and state of environment. Floor plans of interior spaces should reflect furniture design that is functional and appropriate for purpose. Samples of flooring, wall treatments, window coverings and accessories should demonstrate knowledge of design practices.

ELIGIBILITY

Entries are limited to students in a program that has interior design as part of the occupational objective. This may include: Architecture and Construction, Arts, A/V & Communications or Marketing.

TIME LIMITS

Entries must be started and completed during the current school year.

THIS DOCUMENT SHOULD BE THE 2nd ITEM IN YOUR NOTEBOOK AT DISTRICT

REGULATIONS

All Job Exhibits Require a Notebook. Notebook description is found in this document titled Job Exhibit

Notebook. The project notebook should demonstrate core academic abilities. The student should demonstrate the use of proper English, Math, and Science in the project. Academics should be a major emphasis in the notebook.

3D Model representation of the design no larger than 24" x 36" must be submitted with the notebook

- Job Exhibit must be designed, sketched, computer-drawn, developed, and created by students.
- All designs must be the original work of the students.
- Any exhibit that depicts inappropriate or unacceptable designs will be disqualified.
- Individual, Multiple or Chapter

Interior Design Job Exhibit Project Rating Sheet-State

Please place a copy of the rating sheet for each project entry at the front of the report folder.

Dimensions of Exhibit: 24"x36" or smaller, 12" height maximum

The completed district notebook grading sheet with registration sticker and state qualifying stamp should be included in the notebook for state submission with the project. This rating sheet is for the project only at state which will be added to the district notebook grade.

Interior Design Project	Max Points	Points earned
1. Notebook Enter Score from the Job Exhibit Notebook Rating Sheet 200 points possible	200	
2. Design & Originality Demonstrate knowledge of design principles? How creativity were principles implemented?	50	
3. Detail & Material Choices Clients taste reflected? Proper Materials utilized? Responsible choices?	50	
4. Construction of 3D Model Does Model match Notebook? Done to scale?	40	
5. Did Design Satisfy Client Need? Overall effectiveness of Design?	50	
Total Points	400	

Remarks:

Score	STATE
360 - 400	Superior
320 – 359	Excellent
280 – 319	Very Good
0 - 279	N/A

**State Registration Sticker
Should Be Placed Here**

Internetworking Job Exhibits

Students can only enter 1 job exhibit. This project guide is for individual, group, or chapters.

- This category will contain all Cisco or Open Networking projects consisting of but not limited to routers, switches, nodes, and wireless devices.
- The project should be a pre-planned functional project that has a business or home networking objective.
- There is a \$1000/\$2000 max on budget

Judging

There should be a minimum of two judges for each computer, with the scores averaged. Best of Show may be awarded and overall Best of Show in IT.

THIS DOCUMENT SHOULD BE THE 2nd ITEM IN YOUR NOTEBOOK AT DISTRICT

Notebook - see all job exhibit notebook specification sheet for more detail

All Job Exhibits Require a Notebook. Notebook description is found in this document titled Job Exhibit Notebook. The project notebook should demonstrate core academic abilities. The student should demonstrate the use of proper English, Math, and Science in the project. Academics should be a major emphasis in the notebook.

Internetworking Job Exhibit Project Rating Sheet-State

Please place a blank copy of the rating sheet for each project entry at the front of the report folders.

The completed district notebook grading sheet with registration sticker and state qualifying stamp should be included in the notebook for state submission with the project. This rating sheet is for the project only at state which will be added to the district notebook grade. *****Judges, please write in Zeros when no points were earned**

Criteria 1 - Job Occupation (50 Points Max)	Points Awarded	C1 Total
Does the completed job fit the intended purpose of the project proposal? (0-10 points)		
Is the job functional and marketable for its intended audience? (0-15 points)		
Is the design innovative in the IoT Field? (0-15 points)		
Is the project functional? (0-10 points)		
Criteria 2 - Craftsmanship (50 Points Max)		C-2 Total
What is the level of neatness and the quality of the work? (0-20 points)		
Is the completed project aesthetically pleasing? (0-15 points)		
Is there evidence of effort throughout the project's design? (0-15 points)		
Criteria 3 - Complexity (50 Points Max)		C-3 Total
How would you rate the level of difficulty or complexity in the original design or proposal? (0-20 points)		
Does the level of work in the project (hardware and software) reflect the level of difficulty of the overall intended project? (0-30 points)		
Criteria 4 - Operating System (50 Points Max)		C-4 Total
Does the operating system meet the needs of its intended audience? (0-20 points)		
Is the software, applications, programming scripts installed or -created relevant for the project (0-30 points)		
Criteria 5 - Notebook (200 Points Max) <i>Enter Score from Job Exhibit Notebook Rating Sheet</i>	C-5 Total:	
Overall Project Total Possible 400 Points		
Remarks: <i>*If an exhibit is rated less than qualified for state or superior, then the judges should explain why below*</i>		

Score	STATE
360 - 400	Superior
320 – 359	Excellent
280 – 319	Very Good
0 - 279	N/A

**State Registration Sticker
Should Be Placed Here**

Internet of Things Job Exhibit

Students can only enter 1 job exhibit. This project guide is for individual, group, or chapters.

- This category will contain all System on a Chip (SoC) devices that include Raspberry Pis, Arduinos, and other small format microprocessors.
- The project should be a pre-planned functional project that has an IoT networking or offline objective.
- There is a \$250/\$500 max on budget

THIS DOCUMENT SHOULD BE THE 2nd ITEM IN YOUR NOTEBOOK AT DISTRICT

Judging

There should be a minimum of two judges for each computer, with the scores averaged. Best of Show may be awarded and overall Best of Show in IT.

Notebook - see all job exhibit notebook specification sheet for more detail

All Job Exhibits Require a Notebook. Notebook description is found in this document titled Job Exhibit Notebook. The project notebook should demonstrate core academic abilities. The student should demonstrate the use of proper English, Math, and Science in the project. Academics should be a major emphasis in the notebook.

Internet of Things Job Exhibit Project Rating Sheet-State

Please place a copy of the rating sheet for each project entry at the front of the report folders.

The completed district notebook grading sheet with registration sticker and state qualifying stamp should be included in the notebook for state submission with the project. This rating sheet is for the project only at state which will be added to the district notebook grade. *****Judges, please write in Zeros when no points were earned**

Criteria 1 - Job Occupation (50 Points Max)	Points Awarded	C1 Total
Does the completed job fit the intended purpose of the project proposal? (0-10 points)		
Is the job functional and marketable for its intended audience? (0-15 points)		
Is the design innovative in the IoT Field? (0-15 points)		
Is the project functional? (0-10 points)		
Criteria 2 - Craftsmanship (50 Points Max)		
What is the level of neatness and the quality of the work? (0-20 points)		
Is the completed project aesthetically pleasing? (0-15 points)		
Is there evidence of effort throughout the project's design? (0-15 points)		
Criteria 3 - Complexity (50 Points Max)		C-3 Total
How would you rate the level of difficulty or complexity in the original design or proposal? (0-20 points)		
Does the level of work in the project (hardware and software) reflect the level of difficulty of the overall intended project? (0-30 points)		
Criteria 4 - Operating System (50 Points Max)		C-4 Total
Does the operating system meet the needs of its intended audience? (0-20 points)		
Is the software, applications, programming scripts installed or -created relevant for the project (0-30 points)		
Criteria 5 - Notebook (200 Points Max) <i>Enter Score from Job Exhibit Notebook Rating Sheet</i>	C-5 Total:	
Overall Project Total Possible 400 Points		
Remarks: <i>*If an exhibit is rated less than qualified for state or superior, then the judges should explain why below*</i>		

Score	STATE
360 - 400	Superior
320 – 359	Excellent
280 – 319	Very Good
0 - 279	N/A

**State Registration Sticker
Should Be Placed Here**

Landscape Horticulture Job Exhibit

PURPOSE: The student will interpret and evaluate client space and needs and develop a landscape design. Site plan, photographs, and list of desired plant materials will be provided.

OVERVIEW: The student will design the outdoor areas of a residence. The design may include patios, pool/spa, fire features, water features, fences, walkways, or others. Design elements must be appropriately labeled. Plant materials are to be identified by landscape function (i.e., 'large deciduous shade tree') unless specific plants are required as part of the client's needs. The student will also estimate the price of the designed project for client. This step will require careful estimation and application of appropriate materials and costs.

MATERIALS: designing equipment (T-square, triangles, circle template, architects' and engineers' scales, tracing paper, erasers, tape, and parallel roller) and graphic media of choice (pencils, pens, markers, etc.), calculator, sharpened pencils with erasers, and scratch paper. The site plan utilized for the design is 24"x36".

JUDGING:

Points will be assigned based on the following criteria:

1. Meeting the client's needs
2. Conceptual design
3. Functional use of space
4. Design principles and creativity
5. Appropriate selection of plant materials
6. Graphics: clarity, visual interest, color
7. Accurate calculation of design project price

General Notes:

- Review landscape plan, specification, and plant list thoroughly to determine final price for client. Utilize provided plant and materials pricing list to aid in estimate.
- All unit prices include material, installation labor, delivery, overhead and profit for the project unless noted otherwise. The unit price for tree install includes stakes, straps, wire, and mulch.
- For starting take-offs, try a systematic approach of one step at a time.
 - Plant numbers - first - check all quantities / mark each plant off when you count them.
 - Lawn areas - second
 - Bed areas - third
 - Decorative gravels/pavers - fourth
 - Walls - fifth
 - Fence - sixth
- Always round up or down to get total amounts sod, beds, pavers, and mulch.
Example: 1.49 = 1, 1.50 = 2

CLIENT REQUEST:

The Everwoods have decided to renovate their landscape and create a "stay-cation" destination for their relatively large family to gather and enjoy. They have always enjoyed entertaining their family and friends but want the flexibility to do this almost exclusively outside. Off the back of the house, they would like to have a full outdoor kitchen large enough to include a built-in grill, kitchen sink, and refrigerator as well as seating to accommodate 3 barstools. They would like a shade structure over the top to shelter their kitchen and guests from the elements as well as give them the ability to mount a TV for watching football games.

The homeowners currently have a pool but are now interested in adding a hot tub that sits in close proximity and is complementary to the pool. They would also like to add a small cabana/bar structure to be used independently of the outdoor kitchen when having their famous mid-summer pool parties. The pool is the only part of the yard that they would like to be well screened with plant material and are interested in hedges to surround three sides of the pool/hot tub to create this privacy. They would also like a walkway that connects the pool and outdoor kitchen.

The main goal of the Everwoods is to have a landscape that is ideal for entertaining while keeping a natural look to the property. The Everwoods would like many of the following plants incorporated into their landscape:

<u>Plant Type</u>	<u>Botanical/Common Name</u>	<u>Installed Size</u>
Trees	Gleditsia triacanthos f. inermis 'Skycole'	2 ½ " caliper
	Skyline® Thornless Honeylocust	
	Malus 'Prairiefire'	2" caliper
	Prairiefire Crabapple	
	Syringa reticulata 'Ivory Silk'	2" caliper
	Ivory Silk Japanese Tree Lilac	
Shrubs		
	Buxus 'Green Velvet'	18-24" ht.
	Green Velvet Boxwood	
	Euonymus alatus 'Compactus'	#5 container
	Compact Burning Bush	
	Hydrangea paniculata 'Limelight'	#5 container
	Limelight Hydrangea	
	Rosa 'Knockout'	#3 container
	Knockout Rose®	
	Thuja occidentalis 'Nigra'	5-6' ht.
	Dark Green Arborvitae	
Ornamental Grasses		
	Miscanthus sinensis 'Purpurescens'	#2 container
	Purple Maiden Grass	
Perennials		
	Hemerocallis sp. 'Happy Returns'	#1 container
	Happy Returns Daylily	
	Nepeta x faassenii 'Walker's Low'	#1 container
	Walker's Low Catmint	

Landscape Horticulture – Project Rating Sheet-State

Judging Criteria	Points Allowed	Points Awarded	Criteria Total
MEETS CLIENT’S NEEDS (20 Points)			
Design contains requested softscape components	10		
Design contains requested hardscape components	10		
CONCEPTUAL DESIGN & FUNCTIONAL USE OF SPACE (60 Points)			
Design is drawn to scale	20		
Creates a clear distinction between background, middle ground, and foreground	20		
Design is functional	20		
DESIGN PRINCIPLES AND CREATIVITY (40 Points)			
Composition is unified	20		
A variety of textures and patterns are utilized	20		
APPROPRIATE SELECTION OF PLANT MATERIALS (20 Points)			
Plant materials in appropriate location (shade vs sun)	10		
Acceptable grouping of plants, with good repetition and good diversity of materials	10		
GRAPHICS (40 Points)			
Lines are dark and neat with no smudges on the paper	10		
Landscape symbols are appropriate for the selected plant material	10		
Color rendering (pencil or marker)	10		
Each component is properly labeled	10		
ACCURATE CALCULATION OF DESIGN PROJECT PRICE (20 Points)			
Estimate aligns with design	10		
Consistent with provided materials pricing sheet	10		
Notebook: Enter Score from Job Exhibit Notebook Rating Sheet max 200 points	200		
400 Total Points			
Judges Remarks:			

Score	STATE
300 – 350	Superior
250 – 299	Excellent
200 – 249	Very Good
0 – 199	N/A

**State Registration Sticker
Should Be Placed Here**

Photo Panel Job Exhibit

(Texas Only) Students may enter one photo panel. This is an Individual exhibit. Student **may not** enter any other individual job exhibit categories.

ELIGIBILITY

Entries are limited to SkillsUSA Texas members in a Career and Technical program. Photo panels must represent the technical area where the student is enrolled. This is for Middle school and High School students.

PURPOSE

The Photo Panel Contest is designed to encourage students to enter a display **describing the skill learned** in the trade where training has been received.

THIS DOCUMENT SHOULD BE THE 2nd ITEM IN YOUR NOTEBOOK AT DISTRICT

NOTE TO ADVISORS

Each chapter advisor is responsible for screening each member's photo panel so that member photo panels submitted contains outstanding examples of material related to their Career and Technical Education program. Any content deemed inappropriate for a school project will be disqualified. No external media of any type. NO DVD Players, Video or Audio no electrical components.

RULES

1. The photo panel itself will consist of 10 or more photographs of the student-performed tasks associated with a single specific skill learned in the laboratory class.
2. The photo panel shall be displayed on a three-panel foam core or cardboard panel no larger in overall size (all elements included) than 30" by 60" that is self-supporting. When folded the panel must lie flat, nothing adding dimension should be added.
4. Each student will be permitted one entry in the photo panel exhibit.
5. Photo panels are to be student designed, arranged, and completed during the current school year in which the exhibit is to be displayed.
7. Job Exhibit labels will be attached according to general regulations for District and State.
8. The photo panel will be judged as indicated on the rating sheet.

All Job Exhibits Require a Notebook. Notebook description is found in this document titled Job Exhibit Notebook. The project notebook should demonstrate core academic abilities. The student should demonstrate the use of proper English, Math, and Science in the project. Academics should be a major emphasis in the notebook.

Photo Panel Job Exhibit Project Rating Sheet-State

*Please place a copy of the rating sheet for each project entry at the front of the report folder
This is an individual job exhibit, NO multiple or chapter exhibits are allowed.*

Division – Please circle one

Middle School

High School

The completed district notebook grading sheet with registration sticker and state qualifying stamp should be included in the notebook for state submission with the project. This rating sheet is for the project only at state which will be added to the district notebook grade.

The judges will rate each photo panel in accordance with the following ratings, considering the points indicated:

Judging Criteria		Points Allowed	Points Awarded
1.	Exhibit Construction – Maximum Size 30" x 60" – all elements contained	50 Points	
2.	Neatness of the panel	50 Points	
3.	Originality	50 Points	
4.	Technical skill displayed is in scope of the CTE program where student is enrolled	50 Points	
5.	Notebook Score from the Job Exhibit Notebook Rating Sheet 300 points possible	200 Points	
Total Points		400	
*If an exhibit is rated less than qualified for state or superior, then the judges should explain why below:			

Score	STATE
360 - 400	Superior
320 – 359	Excellent
280 – 319	Very Good
0 - 279	N/A

**State Registration Sticker
Should Be Placed Here**

Photography Job Exhibits

CATEGORIES:

Please mark correct category for entry. Projects may only be entered in one category*:

Photography Categories - Best of Show awarded from each of the following categories:

- Photography - General
Anything that would not fall into the following three categories.
- Photography - Portrait
A photograph of a person or group of people that captures the personality of the subject by using effective lighting, backdrops, and poses.
- Photography - Commercial
The creation of images to be used by businesses for selling or promoting their product or brand.

THIS DOCUMENT SHOULD BE THE 2nd ITEM IN YOUR NOTEBOOK AT DISTRICT

Print Quality and Presentation Details

- Matting Details
 - 16 x 20 black over matte w/ 16 x 20 black backing
 - 11 x 14 print, center
 - Matte board over matte
 - Matte board or foam core backing

Must be clean looking and professionally crafted. Free of cosmetic blemishes, scratches, warping, damage, etc.

All photography job exhibits are individual only.

All Job Exhibits Require a Notebook. Notebook description is found in this document titled Job Exhibit Notebook. The project notebook should demonstrate core academic abilities. The student should demonstrate the use of proper English, Math, and Science in the project. Academics and documentation should be a major emphasis in the notebook.

Photography - General Job Exhibit Project Rating Sheet-State

Please place a copy of the rating sheet for each project entry and include it at the front of the report folder.

The completed district notebook grading sheet with registration sticker and state qualifying stamp should be included in the notebook for state submission with the project. This rating sheet is for the project only at state which will be added to the district notebook grade.

The judges will each entry based on the following guidelines. Using the following criteria as a guide, along with their own knowledge of professional photography.

JUDGING CRITERIA		Maximum Points	Points Awarded
1	Impact: Does it capture the intended audience's attention?	20	
2	Composition: Does the use of subject placement, subject grouping, line, texture, forms, and color or tone enhance the center of interest?	20	
3	Artistic Approach: Is the photographer's inspiration or motivation clear?	20	
4	Lighting: Did the photographer choose or use proper lighting for the subject?	20	
5	Exposure: Is the image correctly exposed? Underexposed? Overexposed?	20	
6	Focus: Is the subject in sharp focus? If not in sharp focus, does it enhance the image?	20	
7	Skill: Does the photographer show mastery of photographic skills?	20	
8	Editing Technique: Did the photographer show proper use of editing decision and implementation?	20	
9	Print Quality and Presentation: Were size/mounting requirements met? Does the print/mounting look clean and professional	20	
10	Notebook Score from the Job Exhibit Notebook Rating Sheet	200	
Total Points		400	

Note to Judges: If a job exhibit is rated less than Superior, please explain why in the remarks section of the exhibit hall card or on this rating sheet.

Judges Remarks:

--

Score	STATE
360 - 400	Superior
320 – 359	Excellent
280 – 319	Very Good
0 - 279	N/A

<p>State Registration Sticker Should Be Placed Here</p>
--

Photography - Portrait Job Exhibit Project Rating Sheet-State

The completed district notebook grading sheet with registration sticker and state qualifying stamp should be included in the notebook for state submission with the project. This rating sheet is for the project only at state which will be added to the district notebook grade.

The judges will each entry based on the following guidelines. Using the following criteria as a guide, along with their own knowledge of professional photography.

JUDGING CRITERIA		Maximum Points	Points Awarded
1	Relevance: Is it a photograph of a person or group of people that captures the personality of the subject by using effective lighting, backdrops, and poses?	20	
2	Impact: Does it capture the intended audience's attention?	20	
3	Composition: Does the use of subject placement, subject grouping, line, texture, forms, and color or tone enhance the center of interest?	20	
4	Artistic Approach: Is the photographer's inspiration or motivation clear?	20	
5	Lighting: Did the photographer choose or use proper lighting for the subject?	20	
6	Exposure: Is the image correctly exposed? Underexposed? Overexposed?	20	
7	Focus: Is the subject in sharp focus? If not in sharp focus, does it enhance the image?	20	
8	Skill: Does the photographer show mastery of photographic skills?	20	
9	Editing Technique: Did the photographer show proper use of editing decision and implementation?	20	
10	Print Quality and Presentation: Were size/mounting requirements met? Does the print/mounting look clean and professional	20	
11	Notebook Score from the Job Exhibit Notebook Rating Sheet	200	
Total Points		400	
<p>Note to Judges: If a job exhibit is rated less than Superior, please explain why in the remarks section of the exhibit hall card or on this rating sheet.</p>			
<p>Judges Remarks:</p>			

Score	STATE
360 - 400	Superior
320 – 359	Excellent
280 – 319	Very Good
0 - 279	N/A

**State Registration Sticker
Should Be Placed Here**

Photography - Commercial Job Exhibit Project Rating Sheet-State

The completed district notebook grading sheet with registration sticker and state qualifying stamp should be included in the notebook for state submission with the project. This rating sheet is for the project only at state which will be added to the district notebook grade.

The judges will each entry based on the following guidelines. Using the following criteria as a guide, along with their own knowledge of professional photography.

JUDGING CRITERIA		Maximum Points	Points Awarded
1	Relevance: Is it a photograph that would be used by a business for selling a product or promoting their brand?	20	
2	Impact: Does it capture intended audience's attention?	20	
3	Composition: Does the use of subject placement, subject grouping, line, texture, forms, and color or tone enhance the center of interest?	20	
4	Artistic Approach: Is the photographer's inspiration or motivation clear?	20	
5	Lighting: Did the photographer choose or use proper lighting for the subject?	20	
6	Exposure: Is the image correctly exposed? Underexposed? Overexposed?	20	
7	Focus: Is the subject in sharp focus? If not in sharp focus, does it enhance the image?	20	
8	Skill: Does the photographer show mastery of photographic skills?	20	
9	Editing Technique: Did the photographer show proper use of editing decision and implementation?	20	
10	Print Quality and Presentation: Were size/mounting requirements met? Does the print/mounting look clean and professional	20	
11	Notebook Score from the Job Exhibit Notebook Rating Sheet	200	
Total Points		400	
<p>Note to Judges: If a job exhibit is rated less than Superior, please explain why in the remarks section of the exhibit hall card or on this rating sheet.</p>			
<p>Judges Remarks:</p>			

Score	STATE
360 - 400	Superior
320 – 359	Excellent
280 – 319	Very Good
0 - 279	N/A

**State Registration Sticker
Should Be Placed Here**

Plumbing Job Exhibit

Purpose

A job exhibit that demonstrates plumbing skills in one of the following areas.

- Outdoor use
- Construction grade
- Indoor utility

THIS DOCUMENT SHOULD BE THE 2nd ITEM IN YOUR NOTEBOOK AT DISTRICT

All Job Exhibits Require a Notebook. Notebook description is found in this document titled Job Exhibit Notebook. The project notebook should demonstrate core academic abilities. The student should demonstrate the use of proper English, Math, and Science in the project. Academics should be a major emphasis in the notebook.

Plumbing Job Exhibit Project Rating Sheet-State

Please place a copy of the rating sheet for each project entry at the front of the report folder.

Circle a category: Outdoor use Construction grade Indoor utility

The completed district notebook grading sheet with registration sticker and state qualifying stamp should be included in the notebook for state submission with the project. This rating sheet is for the project only at state which will be added to the district notebook grade.

Judging Criteria	Points Allowed	Points Awarded
1. Is the job typical of the occupation, and does the job show originality and initiative and/or ingenuity on the part of the contestant?	20	
2. Does the job accurately meet the specifications or description submitted with the job, and does it have adequate evidence of the work performed.	20	
3. Does the job meet the standards of the occupation for quality, finish, neatness, pleasing in appearance?	40	
A. Quality	20	
B. Finish	10	
C. Neatness	20	
D. Pleasing in appearance	20	
4. Does the job indicate that considerable study and effort was expended? In its design (if applicable), construction, assembly and/or arrangement.	50	
5. Notebook: Enter Score from Job Exhibit Notebook Rating Sheet	200	
Note to Judges: If an exhibit is rated less than qualified for state or superior, the judges should explain below:		
TOTAL SCORE 400 points possible		

Judges Remarks:

Score	STATE
360 - 400	Superior
320 – 359	Excellent
280 – 319	Very Good
0 - 279	N/A

**State Registration Sticker
Should Be Placed Here**

Precision Machining Job Exhibit Project Rating Sheet-State

Please place a copy of the rating sheet for each project entry at the front of the report folder

All Job Exhibits Require a Notebook. Notebook description is found in this document titled Job Exhibit Notebook. The project notebook should demonstrate core academic abilities. The student should demonstrate the use of proper English, Math, and Science in the project. Academics should be a major emphasis in the notebook.

The completed district notebook grading sheet with registration sticker and state qualifying stamp should be included in the notebook for state submission with the project. This rating sheet is for the project only at state which will be added to the district notebook grade.

Individual and Multiple (2-5)

THIS DOCUMENT SHOULD BE THE 2nd ITEM IN YOUR NOTEBOOK AT DISTRICT

Judging Criteria

- A. Each exhibit should be judged on its own merits.
- B. Try to mark scores in three to five-point reductions.
- C. Write comments or reasons for the reduction.
- D. Each exhibit should be judged against the items on the rating sheet. All exhibits should be completed.
- E. Some exhibits may be entered without the manufacturing processes being done on them. These exhibits were made in school shops where not all manufacturing processes may be available. Some examples are: hardness, surface finish, lettering, coating, surface grinding and kinds of materials used to produce the items.

The judges will rate each exhibit in accordance with the following ratings, considering the points indicated:

JUDGING CRITERIA	Maximum Points	Points Awarded
Notebook Score from the Job Exhibit Notebook Rating Sheet	200	
Surface finish listed on the plans should be neat in appearance or meet industry standards	75	
The exhibit indicates that considerable skills and knowledge was expanded on its construction or fabrication	75	
Does the exhibit meet the specifications shown on the plans	50	
TOTAL POINTS	400	
Note to Judges: If an exhibit is rated less than qualified for state or superior, the judges should explain why below:		
Remarks:		

Score	STATE
360 - 400	Superior
320 – 359	Excellent
280 – 319	Very Good
0 - 279	N/A

**State Registration Sticker
Should Be Placed Here**

Restaurant Model-Culinary Job Exhibit

PURPOSE: The Culinary Restaurant Model job exhibit is designed to encourage students currently enrolled in a culinary CTE program to enter a display *illustrating a working kitchen and service space from skills learned* in the program courses.

Eligibility: Student currently enrolled in a culinary CTE Program. Each student will be permitted one entry in panel exhibit. This may be a team of 2 or individual display.

NOTE TO ADVISORS: Each chapter advisor will screen each member's model so that the model submitted contain examples of a skills related to their culinary Career and Technical Education program. Any content deemed inappropriate for a school project will be disqualified.

THIS DOCUMENT SHOULD BE THE 2nd ITEM IN YOUR NOTEBOOK AT DISTRICT

RULES

1. The model must be no larger than 24" x 36" no more than 12" in height per story.
2. The model must contain 3 dimensional representations of the prep and service spaces.
3. Sample business plan in the body of the notebook containing:
 - a. Name of Business
 - b. Business Concept
 - c. Organization Chart
 - d. Operations Budget
 - e. Logo
 - f. Target Market with 1 specific idea for attracting new customers
 - i. Social media is a medium – not content. Must show the actual content.
 - g. Sample Menu
 - i. Minimum of 12 items (beverages do not count)
 - ii. Design must reflect style of business
 - iii. Must be original work.
 - h. Interior & Design
 - i. Pictures of Uniforms for front and back of house
 - ii. Explain the flow of the restaurant
 - iii. Explain and elaborate on the model and why specific choices were made in the design process.
4. Models are to be student designed, arranged, and completed during the current school year in which the exhibit is to be displayed.
5. The panel will be judged on the standards listed in the score sheet.

All Job Exhibits Require a Notebook. Notebook description is found in this document titled Job Exhibit Notebook. The project notebook should demonstrate core academic abilities. The student should demonstrate the use of proper English, Math, and Science in the project. Academics should be a major emphasis in the notebook.

Restaurant Model Culinary Job Exhibit Project Rating Sheet-State

Please place a blank copy of the rating sheet for each project entry at the front of the report folder.

Model Dimensions: 24" x 36" or smaller, max 12" in height per story, max 24"

The completed district notebook grading sheet with registration sticker and state qualifying stamp should be included in the notebook for state submission with the project. This rating sheet is for the project only at state which will be added to the district notebook grade.

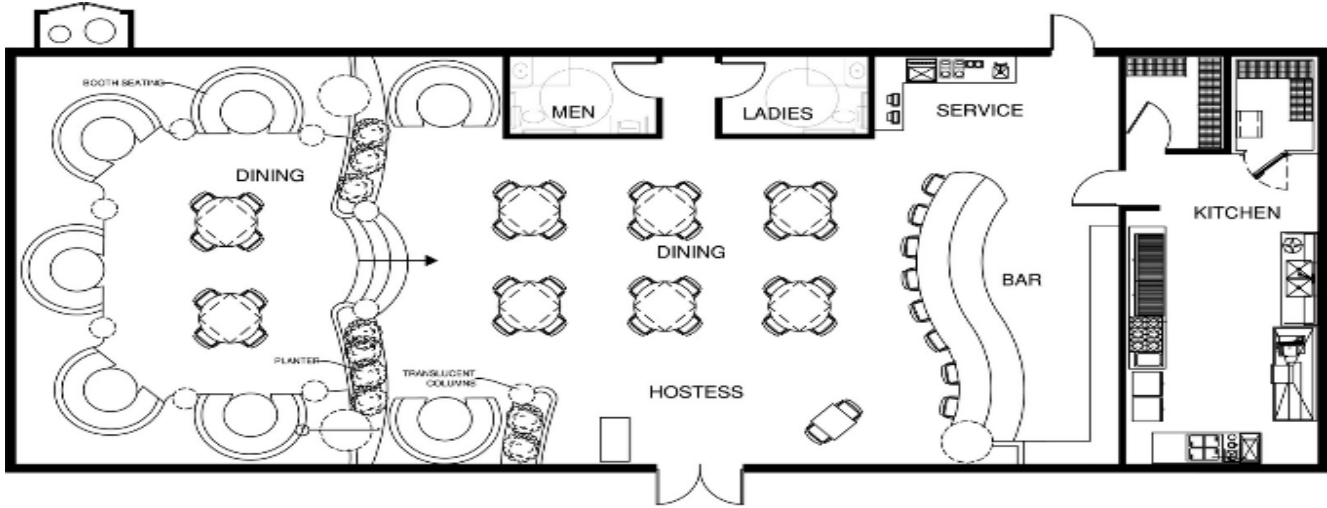

Restaurant Model Project	Max Points	Points earned
Notebook: Enter Score from Job Exhibit Notebook Rating Sheet	200	
Design & Originality	40	
Detail/Construction of model	50	
Business Plan Complete	60	
Budget, Marketing, Menu Align	50	
Total Points 400		

Remarks:

Score	STATE
360 - 400	Superior
320 - 359	Excellent
280 - 319	Very Good
0 - 279	N/A

State Registration Sticker
Should Be Placed Here

Video Production Job Exhibit

A Video Production Job Exhibit is any type of video project created by the registered SkillsUSA student, especially in the categories of Scripted Narrative Video and Short Form Documentary. Video projects are limited to 3 minutes in length and may not include any copyrighted material such as copyrighted music without the inclusion of proof of licensing in the project notebook.

Other non-narrative video products, such as news/sports packages and newscasts do not fall into this job exhibit category.

Your film may contain stock footage as needed for a documentary. Stock footage should not exceed 10% of the total running time.

Individual and Multiple (2-5)

THIS DOCUMENT SHOULD BE THE 2nd ITEM IN YOUR NOTEBOOK AT DISTRICT

Project Submission Details

Please create one folder per job exhibit containing:

1. One video file
 - a. Must be .mp4 or .mov format
 - b. Name video file according to this structure:
CHAPTERNUMBER_STUDENTNAME_PROJECTNAME.mp4
 - c. 10 minutes max
2. One PDF of the project notebook
 - a. Must be a single .PDF file
 - b. Name the notebook file according to this structure:
CHAPTERNUMBER_STUDENTNAME_PROJECTNAME.pdf
3. **All Job Exhibits Require a Notebook. Notebook description is found in this document titled Job Exhibit Notebook.** The project notebook should demonstrate core academic abilities. The student should demonstrate the use of proper English, Math, and Science in the project. Academics should be a major emphasis in the notebook.

Video Production Job Exhibit Project Rating Sheet-State

Please place a copy of the rating sheet for each project entry at the front of the report folder

The completed district notebook grading sheet with registration sticker and state qualifying stamp should be included in the notebook for state submission with the project. This rating sheet is for the project only at state which will be added to the district notebook grade.

The judges will each entry based on the following guidelines. Using the following criteria as a guide, along with their own knowledge of professional video production

Judging Criteria	Points Allowed	Points Awarded
PRODUCTION QUALITY		
Pre-Program: 5 seconds black, 5 seconds slate (chapter number, contestant name), 5 seconds black	20	
Visual: Camera Focus, Exposure, Framing, Movement, Depth, Angles, Lighting	40	
Audio: Levels, Mixing, Use of Music/Effects, Lack of Distortion/Noise	40	
Editing: Shot Selection and Variety, Pacing, Use of Effective Editing Techniques, Graphics	40	
Talent: On Camera Performance, Voice/Narration Performance, Artistic Ability	30	
Originality: Does the project show originality and initiative and/or ingenuity?	30	
Notebook Score from the Job Exhibit Notebook Rating Sheet	200	
400 Total Points		
PENALTIES		
Copyrighted Material: No proof of licensing included.	-50 Points	
Time Penalty: Video is over 10 minutes long.	-10 points/min	
	Total Penalties	
	TOTAL SCORE	

Note to Judges: If an exhibit is rated less than qualified for state or superior, the judges should explain why below:

Remarks:

Score	STATE
360 - 400	Superior
320 – 359	Excellent
280 – 319	Very Good
0 - 279	N/A

**State Registration Sticker
Should Be Placed Here**

Web Page Design Job Exhibit

RULES:

- Individually produced – no teams.
- Contestant will design a web page over the given prompt using any techniques known.
- Scoring will be judged on inclusion of graphics, layout, design, etc.
- May use other programs to help complete the task. (Graphics programs sound recording programs, etc.).
- Exhibit will be displayed with a notebook, guidelines found in general job exhibit guidelines.

PROCEDURE:

- Contestant will be presented with a fictitious “company” for which to make the web page.
- Contestant will also be given information such as price guides, contact information, and general concept of company, etc.
- Contestant will be required to make a custom logo and slogan for the company.
- Two-page minimum required ensuring linking is correct. (no maximum)

KEEP IN MIND:

- Web pages should be original, yet professional.
- Web page helpers (such as Netscape Composer) are permitted.
- Contestant must create ALL portions of the project (including sounds and images). No plagiarism.

FINAL PRODUCT:

- Contestant will submit a form or documentation with name, school name, and the address of his/her page.

JUDGES WILL EVALUATE:

- Overall look and layout
- Graphics
- Coding (HTML) – technique and neatness
- Usage of information given – (How efficient information was used to complete web page).
- Effectiveness
- Eye Appeal
- Professionalism
- Working Links
- Appropriateness

THIS DOCUMENT SHOULD BE THE 2nd ITEM IN YOUR NOTEBOOK AT DISTRICT

All Job Exhibits Require a Notebook. Notebook description is found in this document titled Job Exhibit Notebook. The project notebook should demonstrate core academic abilities. The student should demonstrate the use of proper English, Math, and Science in the project. Academics should be a major emphasis in the notebook.

Web Page Design Job Exhibit Project Rating Sheet-State

Please place a copy of the rating sheet for each project entry at the front of the report folder

The completed district notebook grading sheet with registration sticker and state qualifying stamp should be included in the notebook for state submission with the project. This rating sheet is for the project only at state which will be added to the district notebook grade.

The judges will rate each job in accordance with the following ratings.	Possible Points	Points Awarded
1. Is the job typical of the occupation, and does the job show originality and Initiative and/or ingenuity on the part of the contestant?	50 pts.	
2. Does the job accurately meet the specifications or description submitted with the job, and does it have adequate evidence of the work performed?	50 pts.	
3. Does the job meet the standards of the occupation for quality, finish, neatness, pleasing in appearance?	50 Pts.	
4. Does the job indicate that considerable study and effort was expended in its design, coding, and overall appearance/arrangement?	50 pts.	
5. Notebook Score from the Job Exhibit Notebook Rating Sheet	200	
TOTAL POINTS	400	

Note to Judges: If an exhibit is rated less than qualified for state or superior, the judges should explain why below:

Score	STATE
360 - 400	Superior
320 – 359	Excellent
280 – 319	Very Good
0 - 279	N/A

**State Registration Sticker
Should Be Placed Here**

Welding Job Exhibits All Categories

Purpose

A job exhibit that demonstrates welding skills in one of the following areas.

- **Furniture**
- **Pits**
- **Trailer**
- **General**

Purpose:

To evaluate each contestant's preparation for employment and to recognize outstanding students for excellence and professionalism in the field of electrical trades

Eligibility:

Open to active SkillsUSA members enrolled in programs with welding applications as the occupational objective. Individual, Multiple (2-5) or Chapter (6-50)

Project Requirements:

- Notebook
- Does the quality of work reflect neatness, pleasing esthetics and understanding of necessary welding techniques?
- Does the supporting documentation demonstrate industry standards?
- Is there supporting documentation about where the student got the plans, idea, materials list and steps in the build process?

THIS DOCUMENT SHOULD BE THE 2nd ITEM IN YOUR NOTEBOOK AT DISTRICT

All Job Exhibits Require a Notebook. Notebook description is found in this document titled Job Exhibit Notebook.

The project notebook should demonstrate core academic abilities. The student should demonstrate the use of proper English, Math, and Science in the project. Academics should be a major emphasis in the notebook.

Welding Job Exhibit Project Rating Sheet-State

Please place a copy of the rating sheet for each project entry at the front of the report folder

Circle one: **Furniture** **Pits** **Trailer** **General**

The completed district notebook grading sheet with registration sticker and state qualifying stamp should be included in the notebook for state submission with the project. This rating sheet is for the project only at state which will be added to the district notebook grade.

Judging Criteria		Points Allowed	Points Awarded
1.	Is the job typical of the occupation, and does the job show originality and initiative and/or ingenuity on the part of the contestant?	40	
2.	Does the job accurately meet the specifications or description submitted with the job, and does it have adequate evidence of the work performed.	40	
3.	Does the job meet the standards of the occupation for quality, finish, neatness, pleasing in appearance?		
	A. Weld Quality	30	
	B. Finish	20	
	C. Neatness	20	
	D. Esthetically pleasing to the eye	20	
4.	Does the job indicate that considerable study and effort was expended? in its design (if applicable), construction, assembly and/or arrangement.	30	
5.	NOTEBOOK:	200	
Total Points		400	

Note to Judges: If an exhibit is rated less than qualified for state or superior, the judges should explain why below:

--	--	--

Score	STATE
360 - 400	Superior
320 – 359	Excellent
280 – 319	Very Good
0 - 279	N/A

**State Registration Sticker
Should Be Placed Here**